



REDCAR AND CLEVELAND BOROUGH COUNCIL
MARINE PARADE AREA SALTBURN EXPERIMENTAL TRAFFIC REGULATION ORDER 2026

On 18.6.26, the Council made the above Order under the Road Traffic Regulation Act 1984 (“the Act”) to come into effect on 6.7.26.

The Order, for a period of up to 18 months, will have the effect of amending the Redcar and Cleveland Borough Council (Marske, New Marske and Saltburn)(Waiting and Loading and Parking Places)Consolidation Order 2003 and the Redcar and Cleveland Borough Council (Resident Parking) Consolidation Order 2003 as follows:-

Marine Parade (northern side): The introduction of limited waiting and permit holders only parking within the existing unrestricted marked parking bays. Parking will be limited to a maximum stay of four hours between 09:00 and 17:00, Monday to Saturday, with no return permitted within four hours. Permit holders will be exempt from the restriction. Parking outside of these hours will remain unrestricted. Properties on Marine Parade from Saltburn Road to Garnet Street will be eligible for permits.

Marine Parade (All other areas north of Coral Street Back Street joining Marine Parade): A prohibition on motorhome parking will apply, while unrestricted parking will remain available for all other vehicles.

Marine Parade (south of Coral Street Back Street to the junction of Dundas Street West and Burton Terrace): The introduction of “No Waiting and No Loading” restrictions

Diamond Street and Emerald Street (fronting garages serving De Brus Court): The introduction of “No Loading” restrictions .

Coral Street Back Street joining Garnet Street:The introduction of “No Waiting” restrictions.

Coral Street Back Street joining Marine Parade:The introduction of “No Waiting” restrictions .

A copy of the Order, a statement of the Council’s reasons for making the Order and a location plan may be viewed on the Council’s website [Permanent highway notices | Redcar and Cleveland](#) at the offices below on Monday – Friday between 11 am and 3pm and at Saltburn Library.

The Council will be considering in due course whether the provisions of the Order should be continued in force indefinitely. Within a period of six months from 6.7.26 or if the Order is subsequently varied by another Order under Section 9 of the Act or modified pursuant to Sub Section (2) of Section 10 of the Act from the coming into operation of that variation or modification (whichever is latest) any person may object to the making of an Order for the purposes of such indefinite continuation. Any such objection must be in writing, must give the grounds on which it is made, and must be sent to the undersigned by post for the attention of Business Support Corporate Resources or by email to BusinessSupportCorporateResources@redcar-cleveland.gov.uk

If you wish to question the validity of the Order or of any provision contained in it on the grounds that it is not within the powers conferred by the Act, or on the grounds that any requirement of that Act or of any Instrument made under it has not been complied with in relation to the Order, you may within six weeks from 26.6.26 apply to the High Court for this purpose.

B Archer, Chief Executive, Redcar and Cleveland House, Kirkleatham Street, Redcar TS10 1RT.

REDCAR AND CLEVELAND BOROUGH COUNCIL
MARINE PARADE AREA SALTBURN EXPERIMENTAL TRAFFIC REGULATION ORDER
2026

The Council of the Borough of Redcar and Cleveland (hereinafter referred to as "the Council") under Sections 1, 9, 32, 35, 47, 53 and Part IV of Schedule 9 of the Road Traffic Regulation Act 1984 (hereinafter referred to as the "Act of 1984") and of all other enabling powers and after consultation with the Chief Officer of Police in accordance with Part III of Schedule 9 of the Act of 1984 hereby makes the following Order.

1. This Order shall come into operation on the 6th day of July 2026 for an experimental period of up to 18 months, and may be cited as the Redcar and Cleveland Borough Council Marine Parade Area Saltburn Experimental Traffic Regulation Order 2026.
2. The Redcar and Cleveland Borough Council (Marske, New Marske and Saltburn) (Waiting and Loading and Parking Places) (Consolidation) Order 2003 ("the Order") is hereby amended as follows:-

- a. By adding the following into Schedule 1 No Waiting at any time

Coral Street Back Street Joining Garnet Street Centre, Saltburn by the Sea

- (i) Both sides from its junction with Garnet Street , to its junction with Coral Street

Coral Street Back Street Joining Marine Parade, Saltburn by the Sea

- (i) Both sides from its junction with Marine Parade to its junction with Coral Street

Hilda Place Saltburn by the Sea

- (i) The east side from its junction with Dundas Street West to its junction with Milton Street
- (ii) The west side from its junction with Burton Terrace to its junction with Milton Street

Marine Parade, Saltburn by the Sea

- (i) Both sides from a point 50 metres north of its junction with Milton Street and Hilda Place , to its junction with Coral Street Back Street joining Marine Parade
- (ii) The south side from its junction with Garnet Street, in a north easterly direction for a distance of 10 metres
- (iii) The south east side from its junction with Coral Street in a north easterly direction for a distance of 10 metres
- (iv) The south east side from its junction with Garnet Street in a south westerly direction for a distance of 10 metres
- (v) The south east side from its junction with Coral Street in a south westerly direction for a distance of 10 metres

- b. By adding the following into Schedule 3.4 No Loading/Unloading

Diamond Street Saltburn by the Sea

- (i) The west side from its junction with Marine Parade for a distance of 45 metres in a southerly direction.

Emerald Street Saltburn by the Sea

- (i) The east side from its junction with Marine Parade for a distance of 48 metres in a southerly direction

Hilda Place Saltburn by the Sea

- (i) The east side from its junction with Burton Terrace to its junction with Milton Street
- (ii) The east side from its junction with Dundas Street West to its junction with Milton Street

Marine Parade Saltburn by the Sea

- (i) Both sides from its junction with Milton Street to its junction with Coral Street Back Street joining Marine Parade

Milton Street Saltburn by the Sea

- (i) The south side from its junction with Marine Parade to a point 30 metres from the exit to the supermarket
- (ii) The north side from its junction with Marine Parade to a point 20 metres from its junction with Coral Street

- c. By adding the following definition into Article 2(2)
"Motor Caravan" Has the same meaning as in the Motor Vehicles (Type Approval)(Great Britain) Regulations 1979
- d. By creating a new Schedule 2.94 No waiting Motor Caravans
Save as provided in Articles 45 and 46 of this Order no person shall, except upon the direction or the permission of a Police Officer in uniform or a Civil Enforcement Officer cause or permit any Motor Caravan to wait at any time in the sides and lengths of road specified in Schedule 2.94 of this Order.
- e. By adding the following into Schedule 2.94 No waiting Motor Caravans

Marine Parade, Saltburn by The Sea

- (i) the north side from its junction with Coral Street Back Street joining Marine Parade to its junction with Garnet Street
- (ii) the south side from a point 22 metres east of its junction with Pearl Street, to a point 10 metres west of its junction with Amber Street
- (iii) the south side from a point 10 metres west of its junction with Pearl Street, to a point 10 metres east of its junction with Diamond Street
- (iv) the south side from a point 8 metres west of its junction with Diamond Street, to a point 6 metres east of its junction with Emerald Street
- (v) the south side from a point 5 metres east of its junction with Ruby Street, to a point 6 metres west of its junction with Emerald Street
- (vi) the south side from its junction with Garnet Street, to a point 10 metres north east of its junction with Coral Street
- (vii) the south side from a point 10 metres east of its junction with Amber Street, for a distance of 50 metres in an easterly direction
- (viii) the south-east side from its junction with Coral Street Back Street joining Marine Parade, to a point 10 metres south west of its junction with Coral Street
- (ix) the south-east side from its junction with Garnet Street, to a point 10 metres north east of its junction with Coral Street
- (x) the west side from a point 95 metres south east of its junction with Amber Street, to a point 8 metres north of its junction with Milton Street & Saltburn Road

- f. By creating a new Schedule 7.96 Limited waiting Monday to Saturday 9am-5pm waiting limited to 4 hours no return within 4 hours.

Save as provided in Articles 45 and 48 of this Order no person shall, except upon the direction or the permission of a Police Officer in uniform or a Civil Enforcement Officer , cause or permit any vehicle to wait between the hours of 9am to 5pm from Monday to Saturday inclusive in the sides and lengths of road specified in Schedule 7.96 hereto:-

- (i) for a period longer than 4 hours
- (ii) if a period of less than 4 hours has elapsed since the termination during the said hours of the last period of waiting (if any) by that vehicle on the same same side or length of road.

- g. By adding the following into Schedule 7.96 Limited waiting Monday to Saturday 9am-5pm waiting limited to 4 hours no return with 4 hours
Marine Parade Saltburn The north side from Garnet Street for a distance of 542 metres in an easterly direction to its junction with Milton Street.

3. The Redcar and Cleveland Borough Council (Resident Parking) (Consolidation) Order 2003 (“the Order”) is hereby amended as follows:-

- a. By adding Sub-Schedule 6.36 Zone SB
- b. By adding the following into Sub-Schedule 6.36 Zone SB

PART 1 Premises

Premises entitled to Parking Permits	Conditions relating to permit issue
All properties on Marine Parade between Saltburn Road and Garnet Street	Resident permit- 1 per qualifying vehicle
	Visitor permits – maximum of 2 per property
	Business permits – maximum of 1 per business premises

PART 2 Parking Places

1	2	3	4	5	6
Name of Parking Place	Position in which vehicle may wait	Classes of vehicle	Days of operation of Parking Place	Hours of operation of Parking Place	Maximum period for which vehicles may wait
Marine Parade Saltburn	The north side from Garnet Street for a distance of 524 metres in an easterly direction to its junction with Milton Street	(i)Motor cars within the provisions of Section 136(2)(a) of the Act (ii)Motor cycles as defined in Section 136(4) of the Act (iii)Motor vehicles constructed or adapted for use for the conveyance of goods or burden the laden weight of which does not exceed 2 tonnes	Monday to Saturdays inclusive	9am to 5pm	No maximum

GIVEN under the Common Seal of the Council of the Borough of Redcar and Cleveland this ^{18th} day of June 2026.

THE COMMON SEAL of the COUNCIL OF THE BOROUGH OF REDCAR AND CLEVELAND was hereunto affixed in the presence of :-

[Handwritten signatures]

Authorised signatories



REDCAR AND CLEVELANDBOROUGH COUNCIL MARINE PARADE AREA SALTBURN EXPERIMENTAL TRAFFIC REGULATION ORDER 2026

STATEMENT OF REASONS

The Council has received an increasing volume of complaints regarding the overuse of Marine Parade for motorhome parking. Residents have raised concerns about the concentration of such vehicles along the highway, which has significantly affected the character of the area and its amenity. Parked vehicles particularly on the narrow sections of Marine Parade can also restrict access.

To address the above, various parking and waiting restrictions have been proposed, namely;

- **Marine Parade (northern side):** The introduction of limited waiting and permit holders only within the existing unrestricted marked parking bays. Parking will be limited to a maximum stay of four hours between 09:00 and 17:00, Monday to Saturday, with no return permitted within four hours. Permit holders will be exempt from the restriction. Parking outside of these hours will remain unrestricted. Properties on Marine Parade from Saltburn Road to Garnet Street will be eligible for permits.
- **Marine Parade (All other areas north of Coral Street Back Street joining Marine Parade):** A prohibition on motorhome parking will apply, while unrestricted parking will remain available for all other vehicles. This is intended to release spaces currently occupied by long-stay motorhomes, thereby improving availability for residents, long-stay visitors, and commuters.
- **Marine Parade (south of Coral Street Back Street to the junction of Dundas Street West and Burton Terrace):** The introduction of “No Waiting and No Loading” restrictions to improve highway safety and prevent obstructive parking on the narrowest sections.
- **Diamond Street and Emerald Street (fronting garages serving De Brus Court):** The introduction of “No Loading” restrictions to prevent obstruction to the garages.
- **Coral Street Back Street joining Garnet Street:** The introduction of “No Waiting” restrictions to safeguard access and maintain the free passage of vehicles.
- **Coral Street Back Street joining Marine Parade:** The introduction of “No Waiting” restrictions to safeguard access and maintain the free passage of vehicles.

Following the previous publication of the proposals in October 2025 it has now been agreed to implement those restrictions together with a provision for permits for residents of Marine Parade via an experimental traffic regulation order (ETRO).

The experiment will enable the Council to assess, in real-world conditions, whether the proposed restrictions:

- reduce the concentration and duration of motorhome parking on Marine Parade;
- improve availability of parking for residents and other users;
- address issues of access and obstruction on narrower sections of the road; and
- result in any displacement of parking into surrounding streets.

The Council considers that these impacts are difficult to predict with certainty due to variations in seasonal demand, weather conditions and visitor behaviour, and that an experimental order is

therefore the most appropriate means of evaluating the effectiveness and wider consequences of the proposed measures before any decision is taken on whether they should be made permanent.



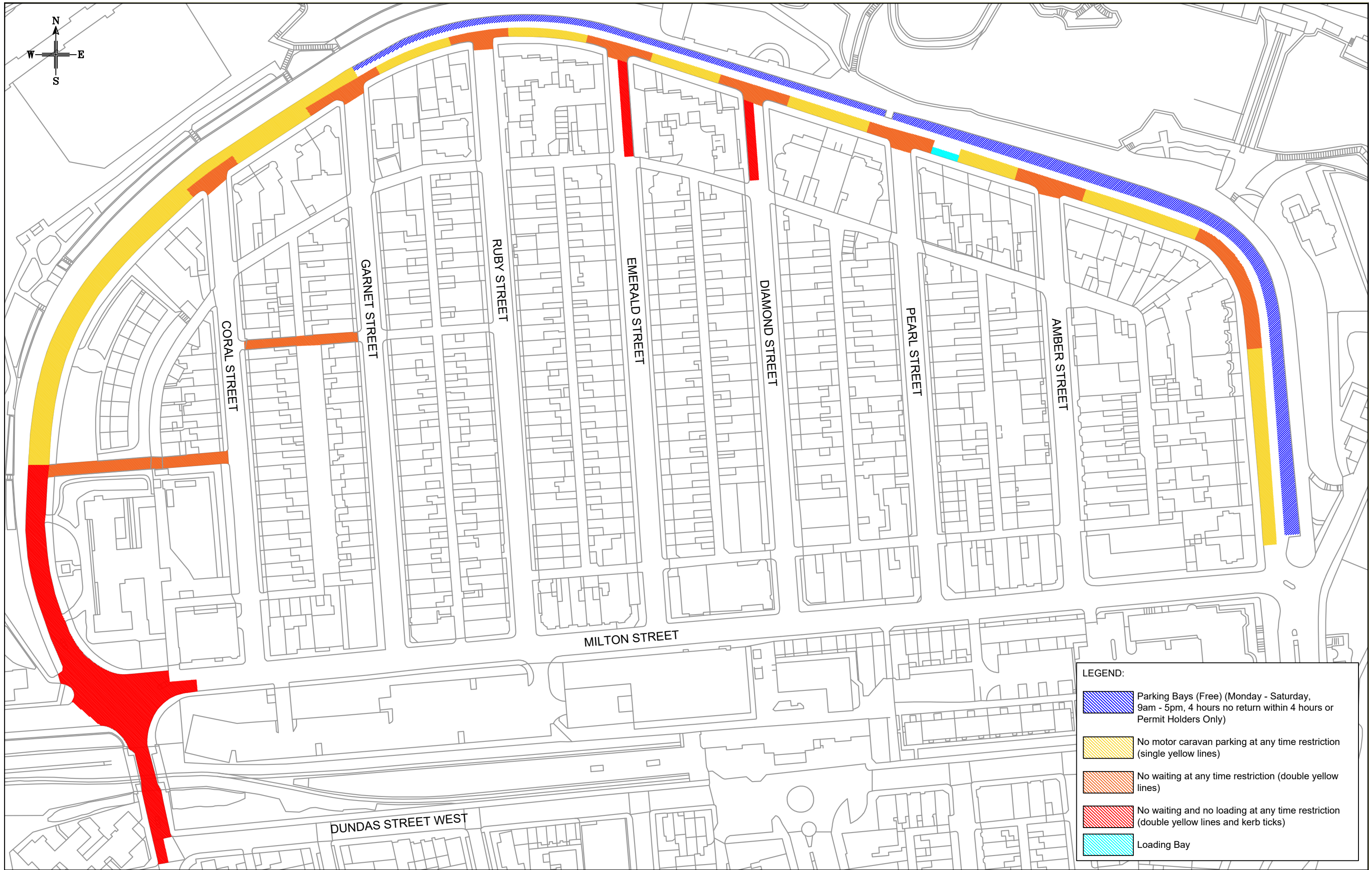

The impact of the experiment will be monitored throughout its duration by way of consideration of objections and other comments received, data collected from the Enforcement team regarding the number of contraventions recorded/Penalty Charge Notices issued and also by officer observations of parking activity on Marine Parade and the wider area of the jewel streets.

In addition to the above, for the following reasons under the reasons listed in section 1 of the Road Traffic Regulation Act 1984, we are proposing the previously stated restrictions.

(a)	for avoiding danger to persons or other traffic using the road or any other road or for preventing the likelihood of any such danger arising, or	
(b)	for preventing damage to the road or to any building on or near the road, or	
(c)	for facilitating the passage on the road or any other road of any class of traffic (including pedestrians), or	✓
(d)	for preventing the use of the road by vehicular traffic of a kind which, or its use by vehicular traffic in a manner which, is unsuitable having regard to the existing character of the road or adjoining property, or	
(e)	(without prejudice to the generality of paragraph (d) above) for preserving the character of the road in a case where it is especially suitable for use by persons on horseback or on foot, or	
(f)	for preserving or improving the amenities of the area through which the road runs	✓
(g)	for any of the purposes specified in paragraphs (a) to (c) of subsection (1) of section 87 of the Environment Act 1995 (air quality)	



LEGEND:

-  Parking Bays (Free) (Monday - Saturday, 9am - 5pm, 4 hours no return within 4 hours or Permit Holders Only)
-  No motor caravan parking at any time restriction (single yellow lines)
-  No waiting at any time restriction (double yellow lines)
-  No waiting and no loading at any time restriction (double yellow lines and kerb ticks)
-  Loading Bay

Project
MARINE PARADE, SALTBURN

Title
TRAFFIC REGULATION ORDER - PROPOSED RESTRICTIONS

Contains Ordnance Survey data © Crown Copyright and database rights 2025 (100019983)

Scale	Hor. NTS	Drawn	DM
	Ver.	Traced	AutoCAD
Date	MAY 2026	Checked	AM



Growth, Enterprise & Environment Directorate

Redcar & Cleveland Borough Council
 Growth, Enterprise & Environment Directorate
 Laing Close,
 Bolckow Industrial Estate,
 Grangetown, Middlesbrough
 TS6 7EA
 Tel: (01642) 455600
 www.redcar-cleveland.gov.uk