



**REDCAR AND CLEVELAND BOROUGH COUNCIL (MARSKE, NEW MARSKE AND
SALTBURN)(WAITING AND LOADING AND PARKING PLACES) CONSOLIDATION ORDER 2003
(AMENDMENT)ORDER NO 2 2025**

The Council proposes to make an Order under the Road Traffic Regulation Act 1984 ("the Act") the effect of which will be to amend the Redcar and Cleveland Borough Council (Marske, New Marske and Saltburn)(Waiting and Loading and Parking Places) Consolidation Order 2003("the Order") as follows:-

1. By introducing no waiting at any time restrictions on the following :-

Coral Street Back Street Joining Garnet Street Centre, Saltburn by The Sea

- (i) both sides from its junction with Garnet Street, to its junction with Coral Street

Coral Street Back Street Joining Marine Parade, Saltburn by The Sea

- (i) both sides from its junction with Marine Parade, to its junction with Coral Street

Hilda Place, Saltburn by The Sea

- (i) the east side from its junction with Dundas Street West, to its junction with Milton Street
- (ii) the west side from its junction with Burton Terrace, to its junction with Milton Street

Marine Parade, Saltburn by The Sea

- (i) both sides from a point 50 metres north of its junction with Milton Street & Hilda Place, to its junction with Coral Street Back Street joining Marine Parade
- (ii) the south side from its junction with Garnet Street, in a north easterly direction for a distance of 10 metres
- (iii) the south-east side from its junction with Coral Street, in a north easterly direction for a distance of 10 metres
- (iv) the south-east side from its junction with Garnet Street, in a south westerly direction for a distance of 10 metres
- (v) the south-east side from its junction with Coral Street, in a south westerly direction for a distance of 10 metres

2. By prohibiting the parking of Motor Caravans on the following:-

Marine Parade, Saltburn by The Sea

- (i) the north side from its junction with Coral Street Back Street joining Marine Parade to its junction with Garnet Street
- (ii) the south side from a point 22 metres east of its junction with Pearl Street, to a point 10 metres west of its junction with Amber Street
- (iii) the south side from a point 10 metres west of its junction with Pearl Street, to a point 10 metres east of its junction with Diamond Street
- (iv) the south side from a point 8 metres west of its junction with Diamond Street, to a point 6 metres east of its junction with Emerald Street

- (v) the south side from a point 5 metres east of its junction with Ruby Street, to a point 6 metres west of its junction with Emerald Street
- (vi) the south side from its junction with Garnet Street, to a point 10 metres north east of its junction with Coral Street
- (vii) the south side from a point 10 metres east of its junction with Amber Street, for a distance of 50 metres in an easterly direction
- (viii) the south-east side from its junction with Coral Street Back Street joining Marine Parade, to a point 10 metres south west of its junction with Coral Street
- (ix) the south-east side from its junction with Garnet Street, to a point 10 metres north east of its junction with Coral Street
- (x) the west side from a point 95 metres south east of its junction with Amber Street, to a point a point 8 metres north of its junction with Milton Street & Saltburn Road

3. By adding No loading/unloading restrictions for all vehicles on the following:-

Diamond Street, Saltburn by The Sea

- (i) the west side from its junction with Marine Parade for a distance of 45 metres in a southerly direction

Emerald Street, Saltburn by The Sea

- (i) the east side from its junction with Marine Parade for a distance of 48 metres in a southerly direction

Hilda Place, Saltburn by The Sea

- (i) the east side from its junction with Burton Terrace, to its junction with Milton Street
- (ii) the east side from its junction with Dundas Street West, to its junction with Milton Street

Marine Parade, Saltburn by The Sea

- (i) both sides from its junction with Milton Street, to its junction with Coral Street Back Street joining Marine Parade

Milton Street, Saltburn by The Sea

- (i) the south side from its junction with Marine Parade to a point 30 metres from the exit to the supermarket
- (ii) the north side from its junction with Marine Parade to a point 20 metres from its junction with Coral Street

4. By introducing free 4 hour parking, no return within 4 hours Monday to Saturday 9am to 5pm on Marine Parade Saltburn by the Sea on the north side from Garnet Street for a distance of 524 metres in an easterly direction to its junction with Milton Street. Free tickets must be obtained and displayed in vehicles.

Full details of the proposal are contained in a draft Order which, together with a statement of the Council's reasons for proposing to make the Orders and a location plan may be examined at the offices below between the hours of 11am and 2pm Monday to Saturday or at <https://www.redcar-cleveland.gov.uk/resident/roads-and-travel/highway-notices/Pages/Permanent-Highway-Notices.aspx>

If you wish to object to the proposed Order you should send the grounds of your objection in writing to the undersigned at the address below for the attention of Emma Garbutt or by email to businesssupportcorporateresources@redcar-cleveland.gov.uk no later than 30.10.25

B Archer, Chief Executive, Redcar and Cleveland House, Kirkleatham Street, Redcar TS10 1RT

**REDCAR AND CLEVELAND BOROUGH COUNCIL
(MARSKE, NEW MARSKE AND SALTBURN) (WAITING AND LOADING AND PARKING
PLACES)
(CONSOLIDATION) (AMENDMENT) ORDER (NO. 2) 2025**

The Council of the Borough of Redcar and Cleveland (hereinafter referred to as “the Council”) under Sections 1, 2, 4, 32, 35, 45, 47, 53 and Part IV of Schedule 9 of the Road Traffic Regulation Act 1984 (hereinafter referred to as the “Act of 1984”) and of all other enabling powers and after consultation with the Chief Officer of Police in accordance with Part III of Schedule 9 of the Act of 1984 hereby makes the following Order.

1. This Order shall come into operation on the day of 2025, and may be cited as the Redcar and Cleveland Borough Council (Marske, New Marske and Saltburn) (Waiting, Loading and Parking Places) (Consolidation) (Amendment) Order (No. 2) 2025
2. The Redcar and Cleveland Borough Council (Marske, New Marske and Saltburn) (Waiting and Loading and Parking Places) (Consolidation) Order 2003 (“the Order”) is hereby amended as follows:-

a. By adding the following into Schedule 1 No Waiting at any time

Coral Street Back Street Joining Garnet Street Centre, Saltburn by the Sea

- (i) Both sides from its junction with Garnet Street , to its junction with Coral Street

Coral Street Back Street Joining Marine Parade, Saltburn by the Sea

- (i) Both sides from its junction with Marine Parade to its junction with Coral Street

Hilda Place Saltburn by the Sea

- (i) The east side from its junction with Dundas Street West to its junction with Milton Street
- (ii) The west side from its junction with Burton Terrace to its junction with Milton Street

Marine Parade, Saltburn by the Sea

- (i) Both sides from a point 50 metres north of its junction with Milton Street and Hilda Place , to its junction with Coral Street Back Street joining Marine Parade
- (ii) The south side from its junction with Garnet Street, in a north easterly direction for a distance of 10 metres
- (iii) The south east side from its junction with Coral Street in a north easterly direction for a distance of 10 metres
- (iv) The south east side from its junction with Garnet Street in a south westerly direction for a distance of 10 metres
- (v) The south east side from its junction with Coral Street in a south westerly direction for a distance of 10 metres

b. By adding the following into Schedule 3.4 No Loading/Unloading

Diamond Street Saltburn by the Sea

- (i) The west side from its junction with Marine Parade for a distance of 45 metres in a southerly direction.

Emerald Street Saltburn by the Sea

- (i) The east side from its junction with Marine Parade for a distance of 48 metres in a southerly direction

Hilda Place Saltburn by the Sea

- (i) The east side from its junction with Burton Terrace to its junction with Milton Street
- (ii) The east side from its junction with Dundas Street West to its junction with Milton Street

Marine Parade Saltburn by the Sea

- (i) Both sides from its junction with Milton Street to its junction with Coral Street Back Street joining Marine Parade

Milton Street Saltburn by the Sea

- (i) The south side from its junction with Marine Parade to a point 30 metres from the exit to the supermarket
 - (ii) The north side from its junction with Marine Parade to a point 20 metres from its junction with Coral Street
- c. By adding the following definition into Article 2(2)
“Motor Caravan” Has the same meaning as in the Motor Vehicles (Type Approval)(Great Britain) Regulations 1979
 - d. By creating a new Schedule 2.94 No waiting Motor Caravans
 - e. By adding the following into Schedule 2.94 No waiting Motor Caravans

Marine Parade, Saltburn by The Sea

- (i) the north side from its junction with Coral Street Back Street joining Marine Parade to its junction with Garnet Street
 - (ii) the south side from a point 22 metres east of its junction with Pearl Street, to a point 10 metres west of its junction with Amber Street
 - (iii) the south side from a point 10 metres west of its junction with Pearl Street, to a point 10 metres east of its junction with Diamond Street
 - (iv) the south side from a point 8 metres west of its junction with Diamond Street, to a point 6 metres east of its junction with Emerald Street
 - (v) the south side from a point 5 metres east of its junction with Ruby Street, to a point 6 metres west of its junction with Emerald Street
 - (vi) the south side from its junction with Garnet Street, to a point 10 metres north east of its junction with Coral Street
 - (vii) the south side from a point 10 metres east of its junction with Amber Street, for a distance of 50 metres in an easterly direction
 - (viii) the south-east side from its junction with Coral Street Back Street joining Marine Parade, to a point 10 metres south west of its junction with Coral Street
 - (ix) the south-east side from its junction with Garnet Street, to a point 10 metres north east of its junction with Coral Street
 - (x) the west side from a point 95 metres south east of its junction with Amber Street, to a point a point 8 metres north of its junction with Milton Street & Saltburn Road
- f. By adding the following into Schedule 5 Pay and Display Parking Places

1	2	3	4	5	6	7
Name of Parking Place	Position in which vehicle may wait	Classes of vehicle	Days of Operation of Parking Place	Hours of operation of Parking Place	Maximum Period for which vehicles may wait	Scale of Charges
Marine Parade Saltburn by the Sea	The north side from Garnet Street for a distance of 524 metres in an easterly direction to its junction with Milton Street	(i) Motorcars, within provisions of Section 136 (2) (a) of the Act. ii) Motor cycles as defined in Section 136 (4) of the Act iii) Motor	Monday to Saturday inclusive	9am-5pm	4 hours no return within 4 hours	Free of charge upon the obtaining and display of a ticket

		vehicles constructed or adapted for use for the conveyance of goods or burden the laden weight of which does not exceed 2 tonnes. iv) Disabled persons vehicles				
--	--	--	--	--	--	--

Given under the Common Seal of the Council of the Borough of Redcar and Cleveland this day of 202 .

THE COMMON SEAL of THE
COUNCIL OF THE BOROUGH
OF REDCAR AND CLEVELAND
was hereunto affixed in the presence
of

Authorised signatories

STATEMENT OF REASONS

The Council has received an increasing volume of complaints regarding the overuse of Marine Parade for motorhome parking. Residents have raised concerns about the concentration of such vehicles along the highway, which has significantly affected the character of the area and its amenity. Parked vehicles particularly on the narrow sections of Marine Parade can also restrict access.



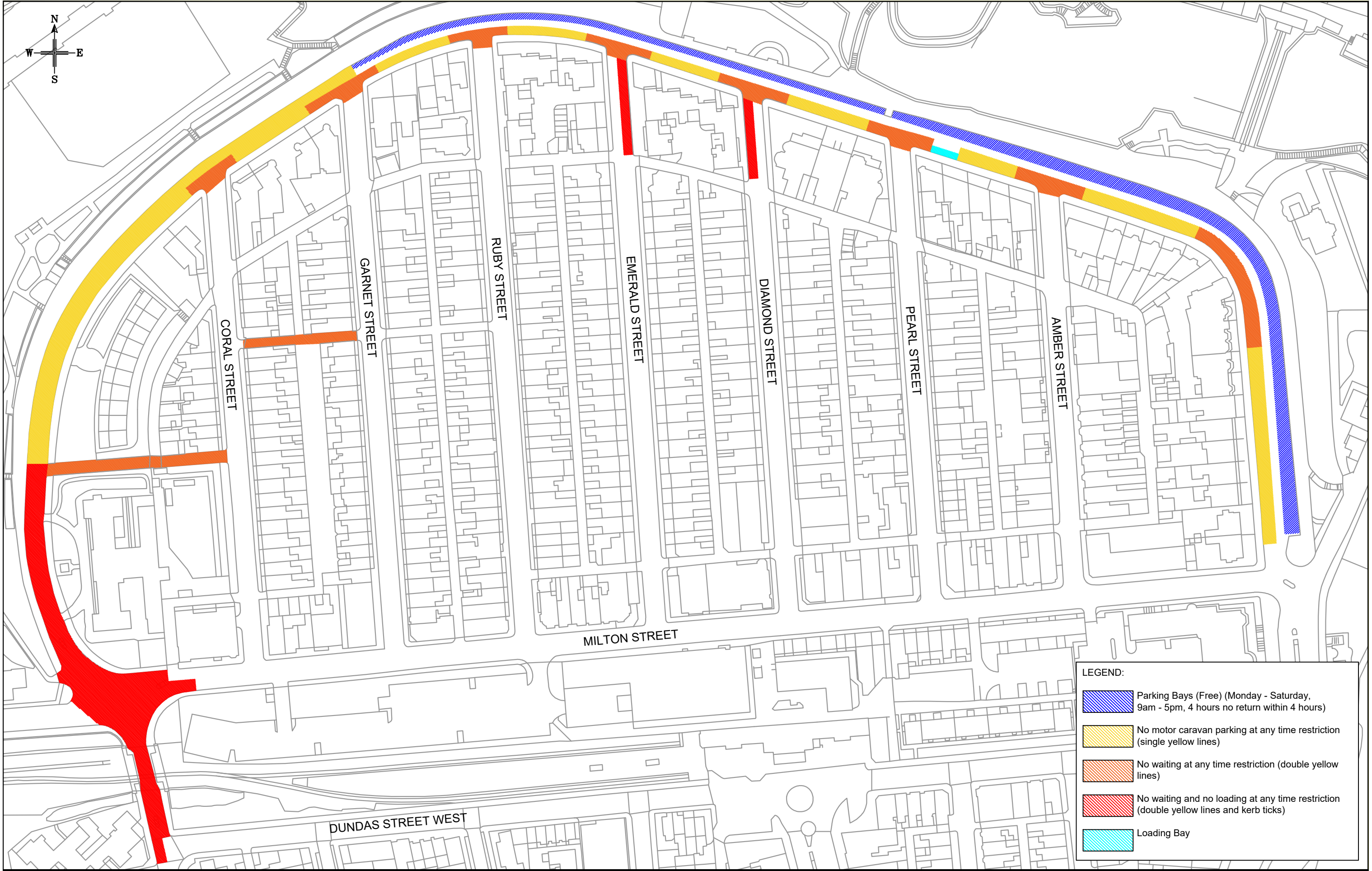

To address the above, various parking and waiting restrictions have been proposed.

In addition to the above, for the following reasons under the reasons listed in section 1 of the Road Traffic Regulation Act 1984, we are proposing the previously stated restrictions.

(a)	for avoiding danger to persons or other traffic using the road or any other road or for preventing the likelihood of any such danger arising, or	
(b)	for preventing damage to the road or to any building on or near the road, or	
(c)	for facilitating the passage on the road or any other road of any class of traffic (including pedestrians), or	✓
(d)	for preventing the use of the road by vehicular traffic of a kind which, or its use by vehicular traffic in a manner which, is unsuitable having regard to the existing character of the road or adjoining property, or	
(e)	(without prejudice to the generality of paragraph (d) above) for preserving the character of the road in a case where it is especially suitable for use by persons on horseback or on foot, or	
(f)	for preserving or improving the amenities of the area through which the road runs	✓
(g)	for any of the purposes specified in paragraphs (a) to (c) of subsection (1) of section 87 of the Environment Act 1995 (air quality)	



LEGEND:

-  Parking Bays (Free) (Monday - Saturday, 9am - 5pm, 4 hours no return within 4 hours)
-  No motor caravan parking at any time restriction (single yellow lines)
-  No waiting at any time restriction (double yellow lines)
-  No waiting and no loading at any time restriction (double yellow lines and kerb ticks)
-  Loading Bay

Project MARINE PARADE, SALTBURN	Title LIMITED WAITING BAYS AND MOTORHOME BAN Contains Ordnance Survey data © Crown Copyright and database rights 2025 (100019983)	Scale	Hor.	NTS	Drawn	DM	 Growth, Enterprise & Environment Directorate	Redcar & Cleveland Borough Council Growth, Enterprise & Environment Directorate Laing Close, Bolckow Industrial Estate, Grangetown, Middlesbrough TS6 7EA Tel: (01642) 455600 www.redcar-cleveland.gov.uk
		Ver.	Traced		AutoCAD			
		Date	JUL 25	Checked	AM			