

PLOT DATE: 07 DECEMBER 2023 15:08
FILE NAME: C:\Users\JAKE\Arden\Management\Projects - Aecom - H2 Teesside\Projects - Aecom - H2 Teesside\IP16 - GIS & CAD Files\073_ARDG_Teesside\ArcPro Projects\Re-Consultation Plans\073_ARDG_H2Teesside_LIC_Batch_3_LOP.aprx

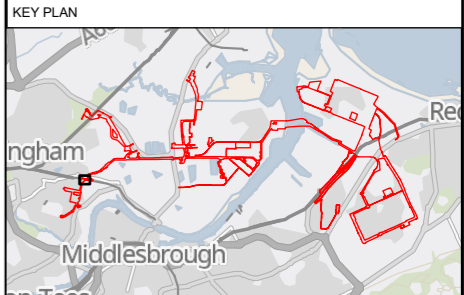
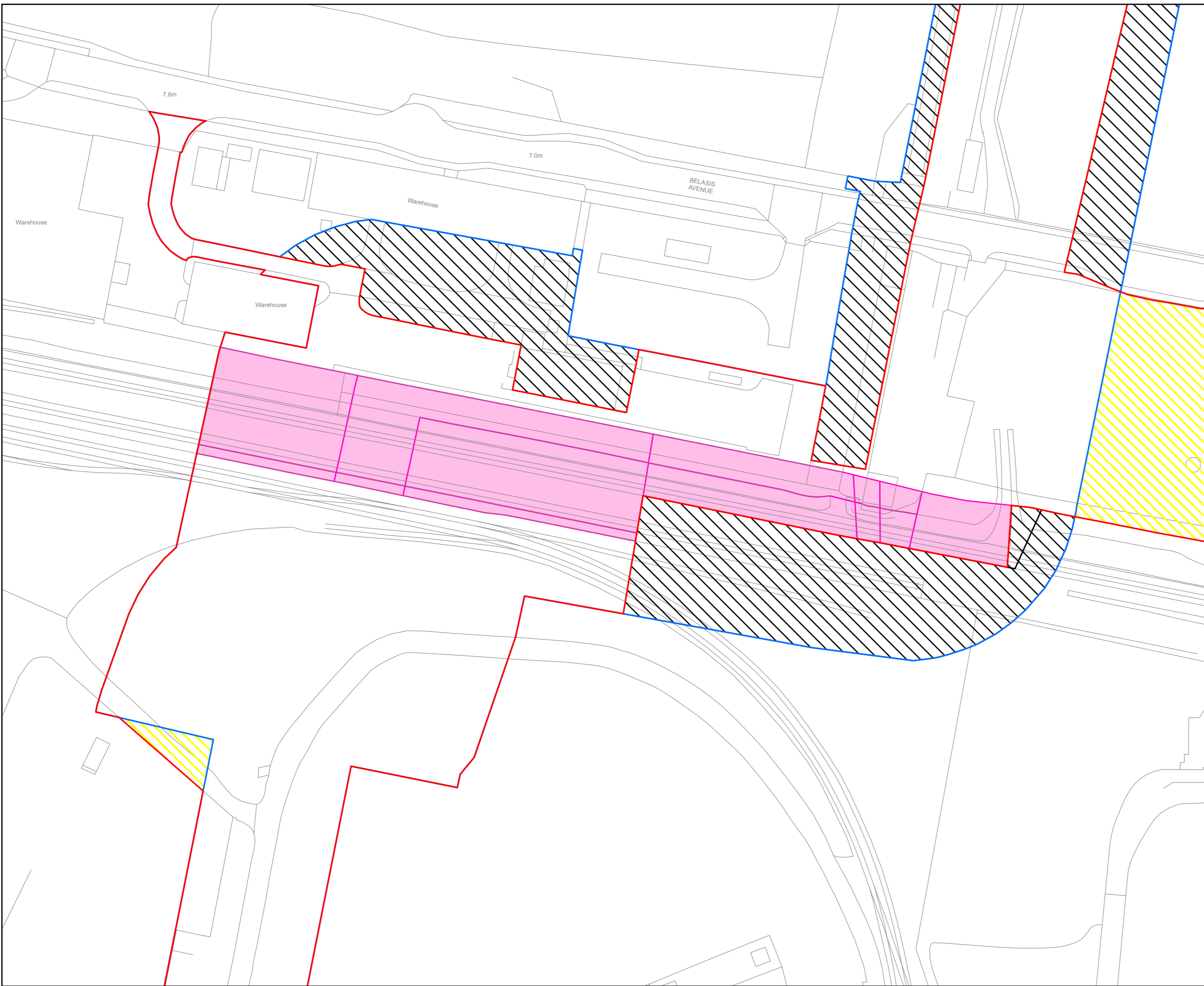

- Key
- Revised Draft Order Limits
 - Order Limits shown at Previous Statutory Consultation
 - Land Interest Boundary
 - Additional Land Area Required
 - Land Area Reduced

© Crown copyright and database rights 2023 Ordnance Survey 0100031673. You are permitted to use this data solely to enable you to respond to, or interact with, the organisation that provided you with the data. You are not permitted to copy, sub-licence, distribute or sell any of this data to third parties in any form.

© Crown copyright material is reproduced with the permission of Land Registry under delegated authority from the Controller of HMSO.

This material was last updated in September 2023 and may not be copied, distributed, sold or published without the formal permission of Land Registry. Only an official copy of a title plan or register obtained from the Land Registry may be used for legal or other official purposes.

May contain public sector information licensed under the Open Government Licence v3.0.



Project: H2 TEESSIDE

Drawing Title: STAGE 2 CONSULTATION LAND INTEREST PLAN NETWORK RAIL INFRASTRUCTURE LIMITED SHEET 1 OF 9

Status: FINAL	Revision: 000
Scale: 1:1,000 @ A3	Date: 07/12/2023

Drawn By: J.NEYE-SWIFT	Checked By: N/A	Approved By: J.WITHINGTON
------------------------	-----------------	---------------------------

Drawing reference: 073_ARDG_H2Teesside_LIC

This document is not to be used in whole or in part other than for the intended purpose and project for which it was prepared and provided.

Plot Date: 07 December 2023 15:08
 File Name: C:\Users\Jake\Arden\Management\Projects\H2 Teesside\Projects - ArcCom - H2 Teesside\IP16 - GIS & CAD Files\073_ARDG_Teeside\ArcPro Projects\Re-Consultation Plans\073_ARDG_H2Teesside_LIC_Batch_3_LOP.aprx

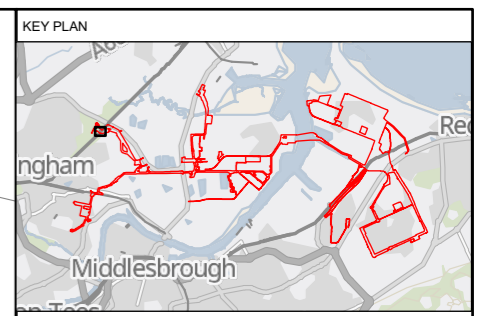
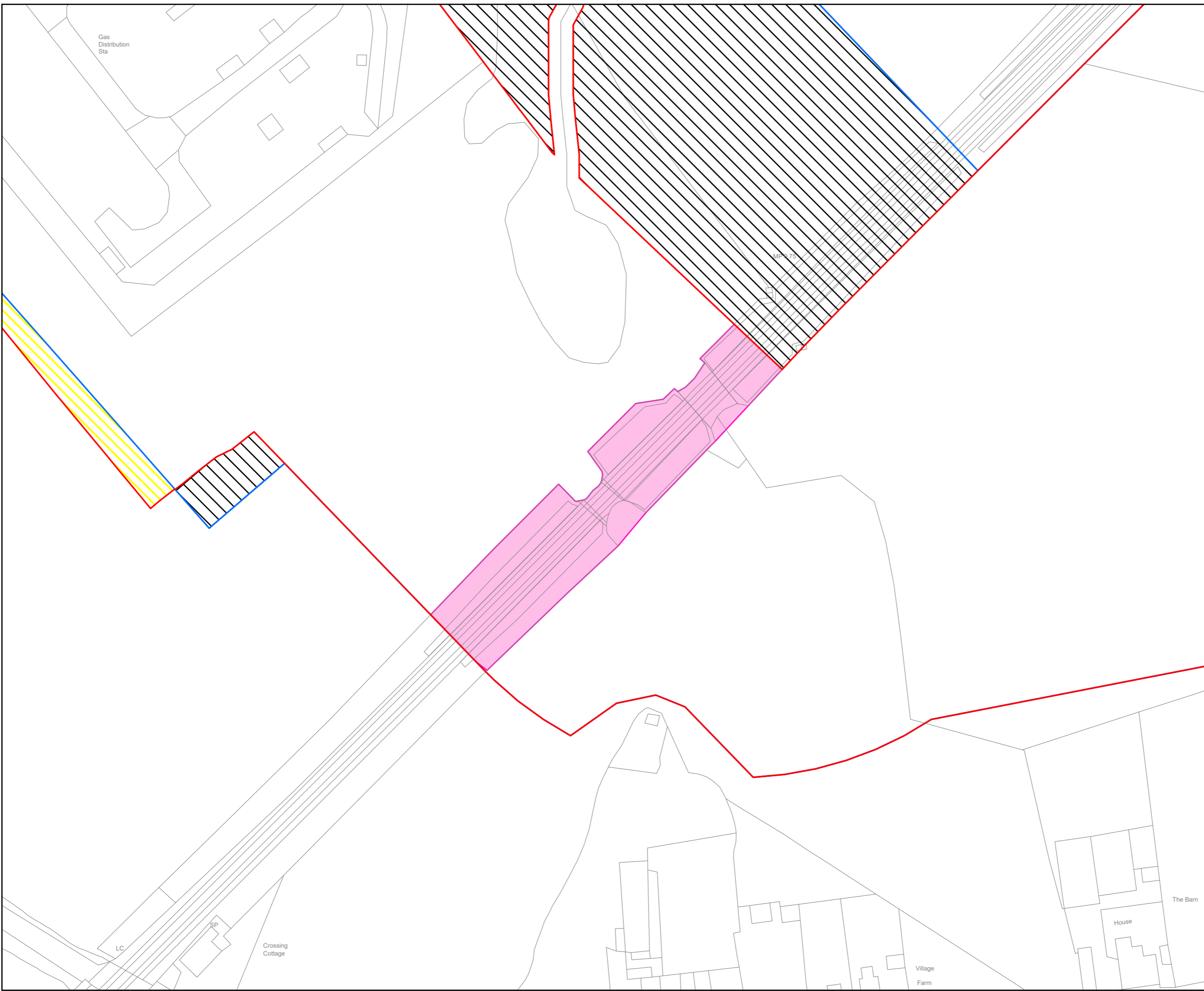

- Key
- Revised Draft Order Limits
 - Order Limits shown at Previous Statutory Consultation
 - Land Interest Boundary
 - Additional Land Area Required
 - Land Area Reduced

© Crown copyright and database rights 2023 Ordnance Survey 0100031673. You are permitted to use this data solely to enable you to respond to, or interact with, the organisation that provided you with the data. You are not permitted to copy, sub-licence, distribute or sell any of this data to third parties in any form.

© Crown copyright material is reproduced with the permission of Land Registry under delegated authority from the Controller of HMSO.

This material was last updated in September 2023 and may not be copied distributed, sold or published without the formal permission of Land Registry. Only an official copy of a title plan or register obtained from the Land Registry may be used for legal or other official purposes.

May contain public sector information licensed under the Open Government Licence v3.0.



Project: H2 TEESSIDE

Drawing Title: STAGE 2 CONSULTATION LAND INTEREST PLAN NETWORK RAIL INFRASTRUCTURE LIMITED SHEET 2 OF 9

Status: FINAL	Revision: 000
Date: 07/12/2023	

Scale: 1:1,000 @ A3 Spatial Reference System: British National Grid

Drawn By: J.NEYE-SWIFT	Checked By: N/A	Approved By: J.WITHINGTON
------------------------	-----------------	---------------------------

Drawing reference: 073_ARDG_H2Teesside_LIC

This document is not to be used in whole or in part other than for the intended purpose and project for which it was prepared and provided.

Plot Date: 07 December 2023 15:08
 File Name: C:\Users\JW\OneDrive\Arden Management Ltd\Projects - Aecom - H2 Teesside\PI16 - GIS & CAD Files\073_ARDG - Teesside\ArcPro Projects\Re-Consultation Plans\073_ARDG_H2Teesside_LIC_Batch_3_LOP.aprx

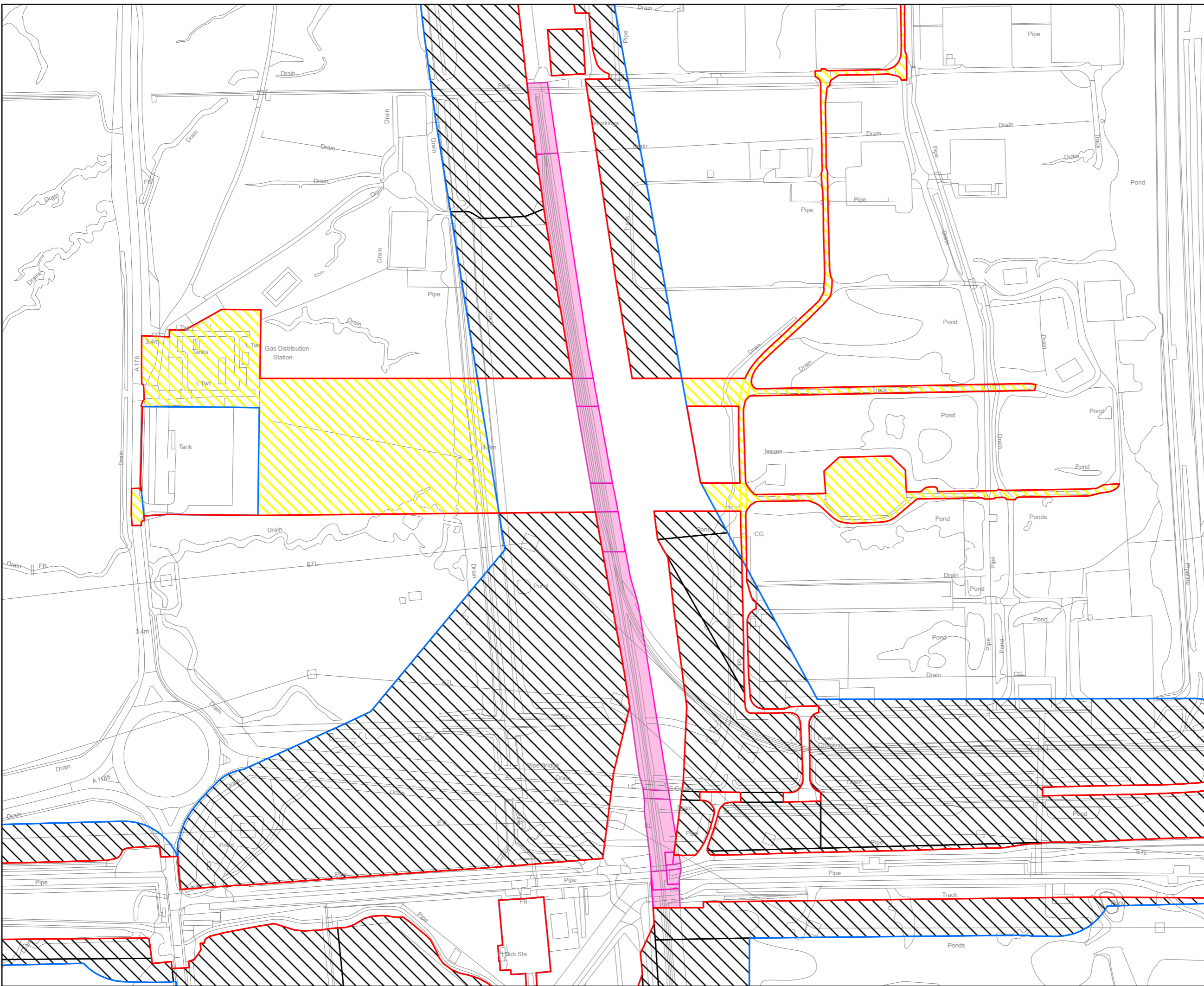

KEY PLAN

Key

- Revised Draft Order Limits
- Order Limits shown at Previous Statutory Consultation
- Land Interest Boundary
- Additional Land Area Required
- Land Area Reduced

© Crown copyright and database rights 2023 Ordnance Survey 0100031673. You are permitted to use this data solely to enable you to respond to, or interact with, the organisation that provided you with the data. You are not permitted to copy, sub-licence, distribute or sell any of this data to third parties in any form.

© Crown copyright material is reproduced with the permission of Land Registry under delegated authority from the Controller of HMSO.

This material was last updated in September 2023 and may not be copied, distributed, sold or published without the formal permission of Land Registry. Only an official copy of a title plan or register obtained from the Land Registry may be used for legal or other official purposes.

May contain public sector information licensed under the Open Government Licence v3.0.

Client

Designer

Project

H2 TEESSIDE

Drawing Title

STAGE 2 CONSULTATION
LAND INTEREST PLAN
NETWORK RAIL INFRASTRUCTURE LIMITED
SHEET 3 OF 9

Status	FINAL	Revision	000
Scale	1:3,000 @ A3	Date	07/12/2023
Spatial Reference System	British National Grid		

Drawn By	Checked By	Approved By
J.NEYE-SWIFT	N/A	J.WITHINGTON

Drawing reference: 073_ARDG_H2Teesside_LIC

This document is not to be used in whole or in part other than for the intended purpose and project for which it was prepared and provided.

Plot Date: 07 December 2023 15:08
File Name: C:\Users\Jake\Arden\Management\Projects - Aecom - H2 Teesside\IP16 - GIS & CAD Files\073_ARDG_Teesside\Arden\Projects\Re-Consultation Plans\073_ARDG_H2Teesside_LIC_Batch_3_LOP.aprx

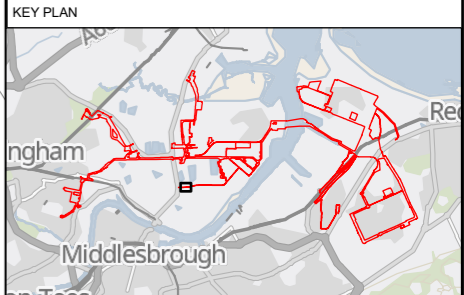
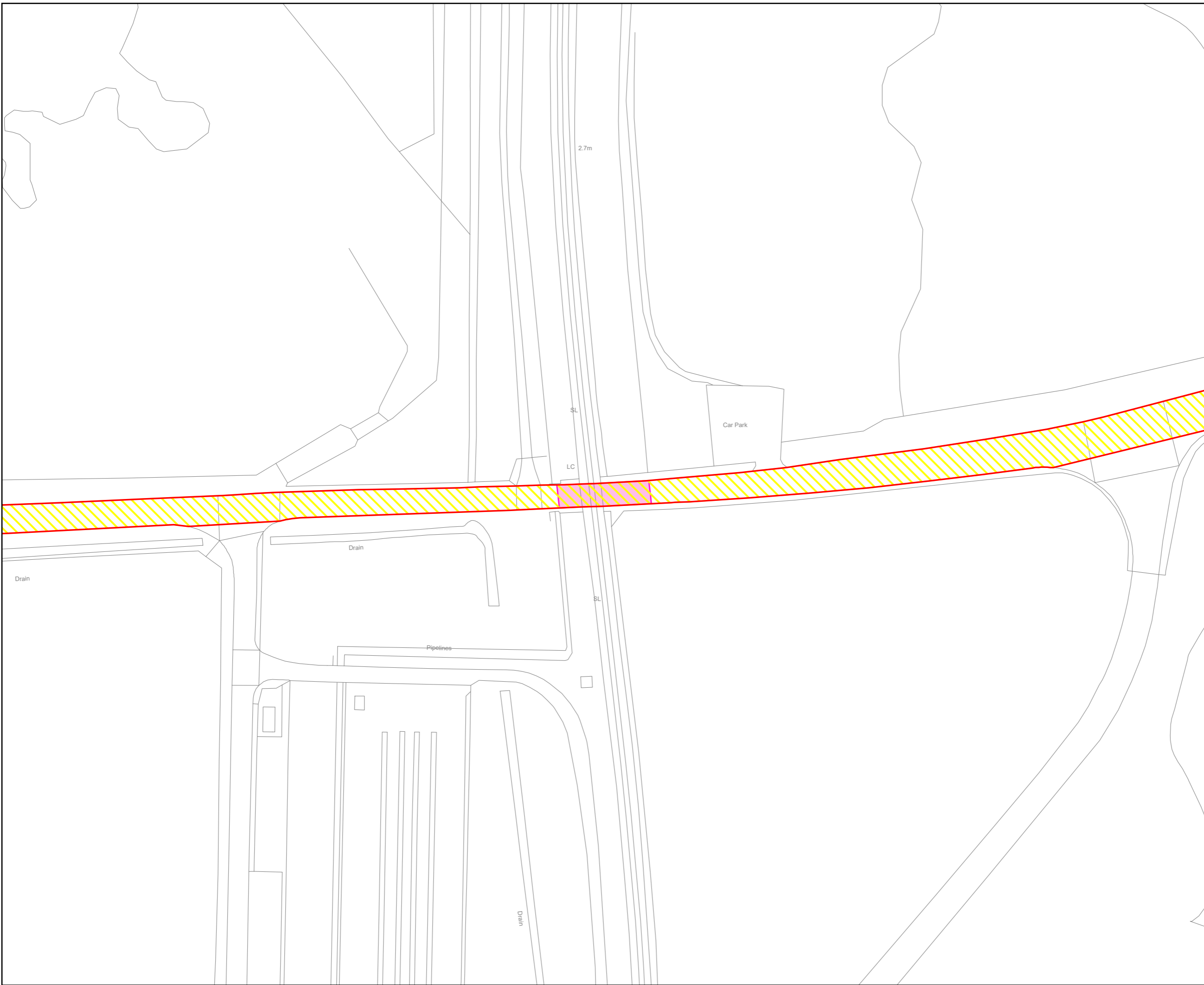

- Key
- Revised Draft Order Limits
 - Land Interest Boundary
 - Additional Land Area Required

© Crown copyright and database rights 2023 Ordnance Survey 0100031673. You are permitted to use this data solely to enable you to respond to, or interact with, the organisation that provided you with the data. You are not permitted to copy, sub-licence, distribute or sell any of this data to third parties in any form.

© Crown copyright material is reproduced with the permission of Land Registry under delegated authority from the Controller of HMSO.

This material was last updated in September 2023 and may not be copied, distributed, sold or published without the formal permission of Land Registry. Only an official copy of a title plan or register obtained from the Land Registry may be used for legal or other official purposes.

May contain public sector information licensed under the Open Government Licence v3.0.

Client

Designer

Project

H2 TEESSIDE

Drawing Title

STAGE 2 CONSULTATION
LAND INTEREST PLAN
NETWORK RAIL INFRASTRUCTURE LIMITED
SHEET 4 OF 9

Status	FINAL	Revision	000
Date	07/12/2023		

Scale 1:1,000 @ A3 Spatial Reference System British National Grid



Drawn By	Checked By	Approved By
J.NEYE-SWIFT	N/A	J.WITHINGTON



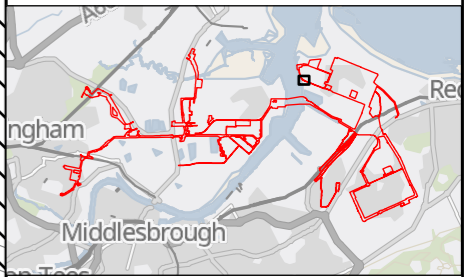

Drawing reference 073_ARDG_H2Teesside_LIC

This document is not to be used in whole or in part other than for the intended purpose and project for which it was prepared and provided.

KEY PLAN



Key

-  Revised Draft Order Limits
-  Order Limits shown at Previous Statutory Consultation
-  Land Interest Boundary
-  Land Area Reduced

© Crown copyright and database rights 2023 Ordnance Survey 0100031673. You are permitted to use this data solely to enable you to respond to, or interact with, the organisation that provided you with the data. You are not permitted to copy, sub-licence, distribute or sell any of this data to third parties in any form.

© Crown copyright material is reproduced with the permission of Land Registry under delegated authority from the Controller of HMSO.

This material was last updated in September 2023 and may not be copied, distributed, sold or published without the formal permission of Land Registry. Only an official copy of a title plan or register obtained from the Land Registry may be used for legal or other official purposes.

May contain public sector information licensed under the Open Government Licence v3.0.

Client



Designer
Ardent

Project

H2 TEESSIDE

Drawing Title

STAGE 2 CONSULTATION
LAND INTEREST PLAN
NETWORK RAIL INFRASTRUCTURE LIMITED
SHEET 5 OF 9

Status	FINAL	Revision	000
Date	07/12/2023		

Scale	1:1,000 @ A3	Spatial Reference System	British National Grid
-------	--------------	--------------------------	-----------------------

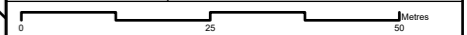

Drawn By	Checked By	Approved By
J.NEYE-SWIFT	N/A	J.WITHINGTON

Drawing reference 073_ARDG_H2Teesside_LIC

This document is not to be used in whole or in part other than for the intended purpose and project for which it was prepared and provided.

Plot Date: 07 December 2023 15:08
 File Name: C:\Users\jake\Arden\Management\ltd\Projects - Arden - H2 Teesside\IP16 - GIS & CAD Files\073_ARDG - Teesside\Arden\Projects\Re-Consultation Plans\073_ARDG_H2Teesside_LIC_Batch_3_LOP.aprx

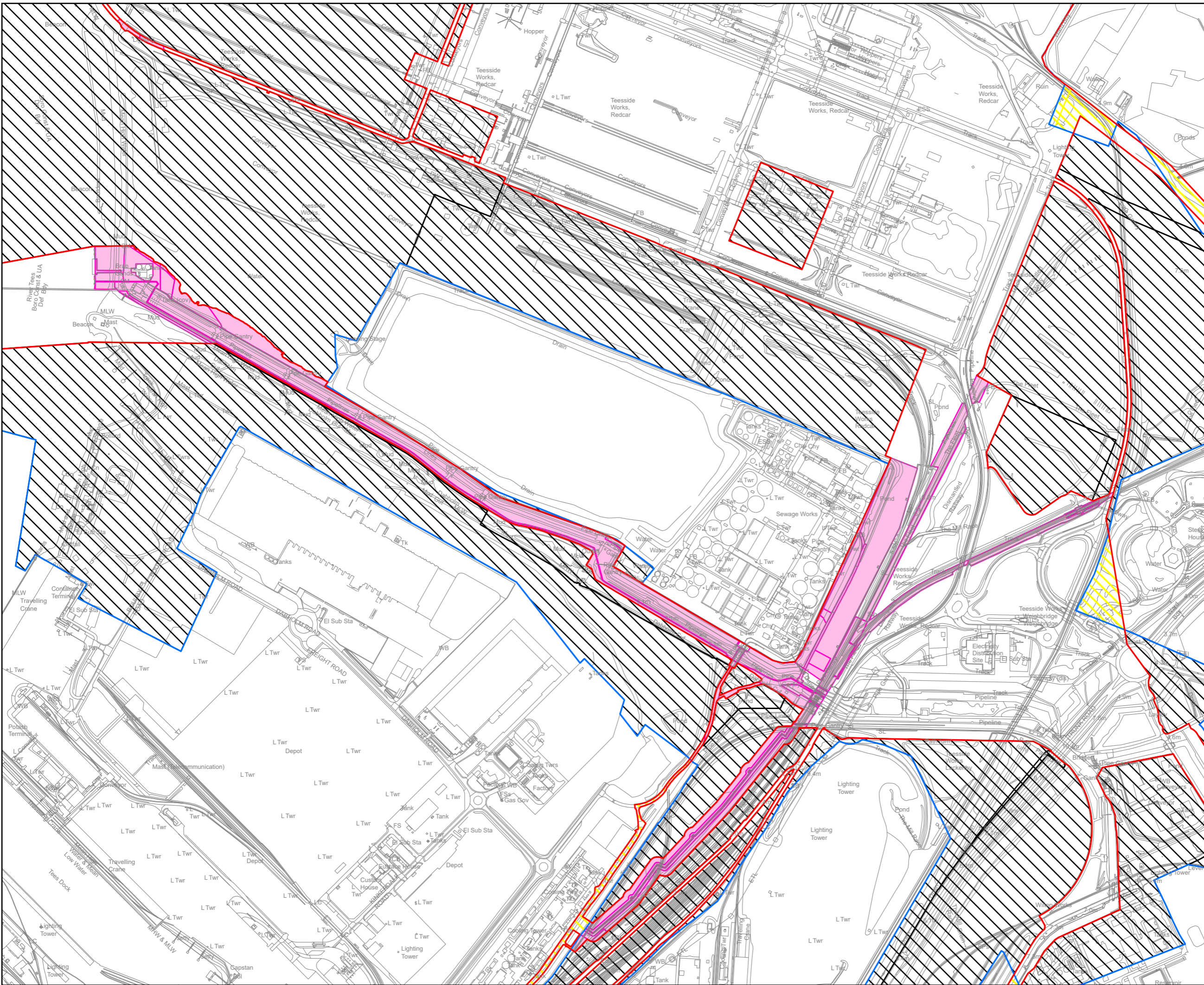

KEY PLAN

Key

- Revised Draft Order Limits
- Order Limits shown at Previous Statutory Consultation
- Land Interest Boundary
- Additional Land Area Required
- Land Area Reduced

© Crown copyright and database rights 2023 Ordnance Survey 0100031673. You are permitted to use this data solely to enable you to respond to, or interact with, the organisation that provided you with the data. You are not permitted to copy, sub-licence, distribute or sell any of this data to third parties in any form.

© Crown copyright material is reproduced with the permission of Land Registry under delegated authority from the Controller of HMSO.

This material was last updated in September 2023 and may not be copied distributed, sold or published without the formal permission of Land Registry. Only an official copy of a title plan or register obtained from the Land Registry may be used for legal or other official purposes.

May contain public sector information licensed under the Open Government Licence v3.0.

Client

Designer

Project

H2 TESSIDE

Drawing Title

**STAGE 2 CONSULTATION
LAND INTEREST PLAN
NETWORK RAIL INFRASTRUCTURE LIMITED
SHEET 6 OF 9**

Status	FINAL	Revision	000
Date	07/12/2023		
Scale	1:9,000 @ A3	Spatial Reference System	British National Grid

Drawn By	J.NEYE-SWIFT	Checked By	N/A	Approved By	J.WITHINGTON
Drawing reference	073_ARDG_H2Teesside_LIC				

This document is not to be used in whole or in part other than for the intended purpose and project for which it was prepared and provided.

Plot Date: 07 December 2023 15:08
File Name: C:\Users\JW\OneDrive\Management\Projects - Aecom - H2 Teesside\Projects - Aecom - H2 Teesside\IP16 - GIS & CAD Files\073_ARDG_H2Teesside\Re-Consultation Plans\073_ARDG_H2Teesside_LIC_Batch_3_LOP.aprx

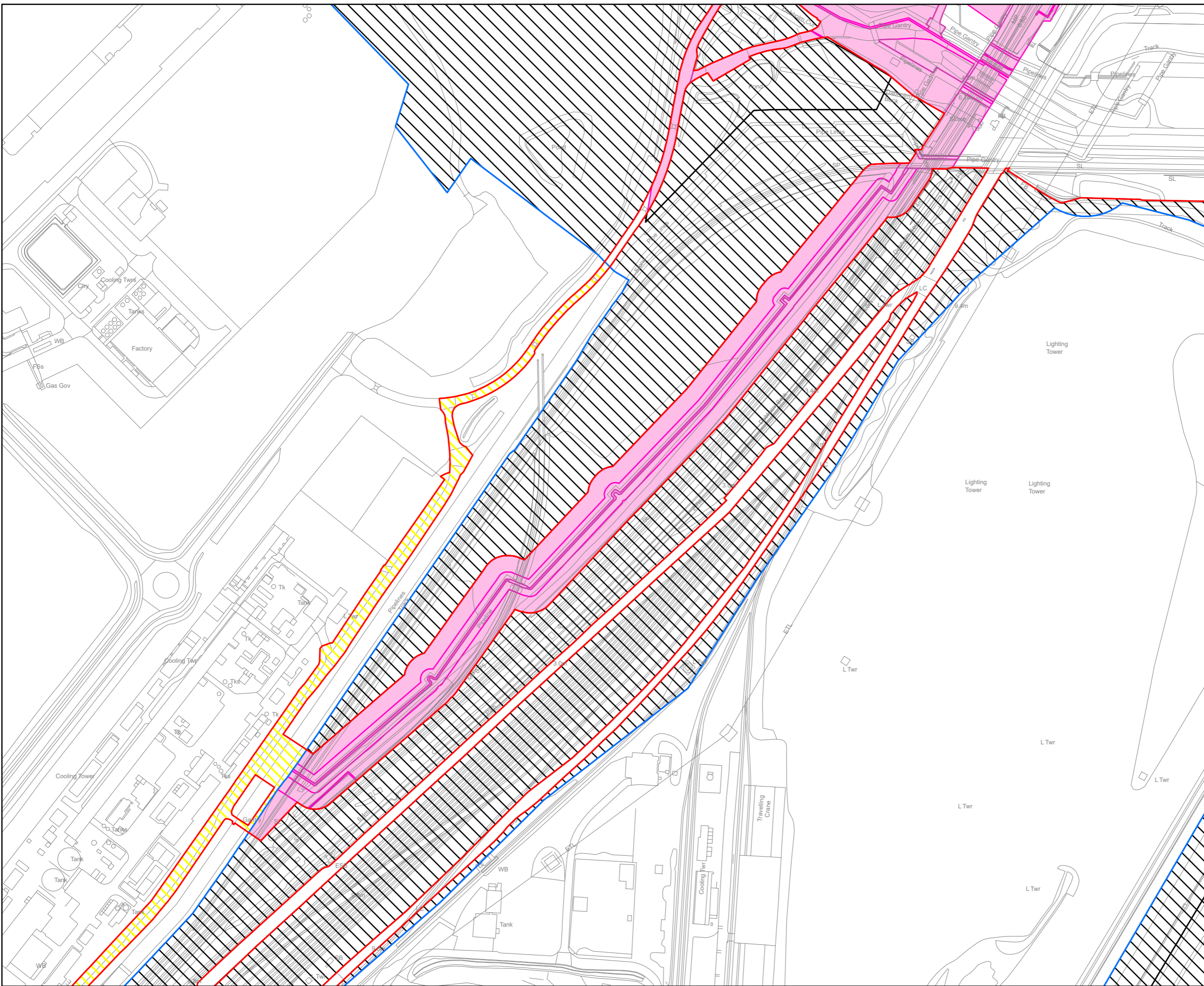

KEY PLAN

Key

- Revised Draft Order Limits
- Order Limits shown at Previous Statutory Consultation
- Land Interest Boundary
- Additional Land Area Required
- Land Area Reduced

© Crown copyright and database rights 2023 Ordnance Survey 0100031673. You are permitted to use this data solely to enable you to respond to, or interact with, the organisation that provided you with the data. You are not permitted to copy, sub-licence, distribute or sell any of this data to third parties in any form.

© Crown copyright material is reproduced with the permission of Land Registry under delegated authority from the Controller of HMSO.

This material was last updated in September 2023 and may not be copied distributed, sold or published without the formal permission of Land Registry. Only an official copy of a title plan or register obtained from the Land Registry may be used for legal or other official purposes.

May contain public sector information licensed under the Open Government Licence v3.0.

Client

Designer

Project

H2 TEESSIDE

Drawing Title

**STAGE 2 CONSULTATION
LAND INTEREST PLAN
NETWORK RAIL INFRASTRUCTURE LIMITED
SHEET 7 OF 9**

Status	FINAL	Revision	000
Scale	1:3,000 @ A3	Date	07/12/2023
Spatial Reference System	British National Grid		

Drawn By	Checked By	Approved By
J.NEYE-SWIFT	N/A	J.WITHINGTON

Drawing reference: 073_ARDG_H2Teesside_LIC

This document is not to be used in whole or in part other than for the intended purpose and project for which it was prepared and provided.

Plot Date: 07 December 2023 15:08
File Name: C:\Users\Jake\Arden\Management\Projects - Aecom - H2 Teesside\Projects - Aecom - H2 Teesside\IP16 - GIS & CAD Files\073_ARDG_Teesside\ArcPro - Consultation Plans\073_ARDG_H2Teesside_LIC_Batch_3_LOP.aprx

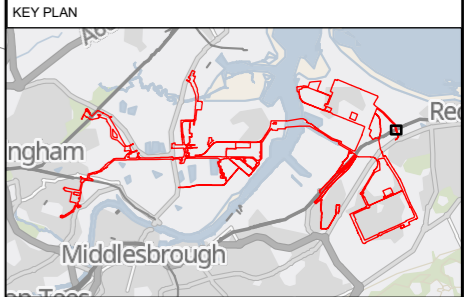
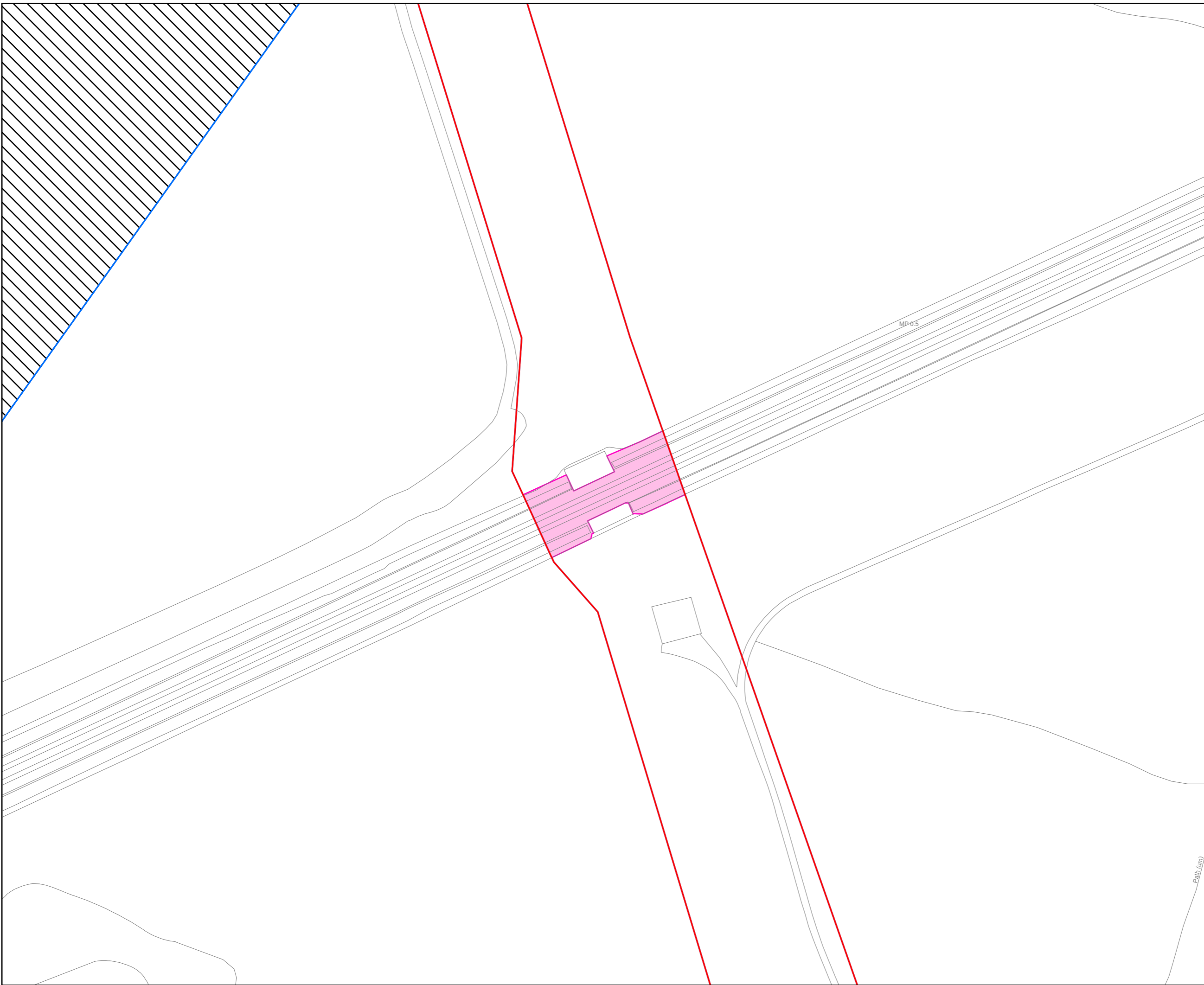

- Key
- Revised Draft Order Limits
 - Order Limits shown at Previous Statutory Consultation
 - Land Interest Boundary
 - Land Area Reduced

© Crown copyright and database rights 2023 Ordnance Survey 0100031673. You are permitted to use this data solely to enable you to respond to, or interact with, the organisation that provided you with the data. You are not permitted to copy, sub-licence, distribute or sell any of this data to third parties in any form.

© Crown copyright material is reproduced with the permission of Land Registry under delegated authority from the Controller of HMSO.

This material was last updated in September 2023 and may not be copied, distributed, sold or published without the formal permission of Land Registry. Only an official copy of a title plan or register obtained from the Land Registry may be used for legal or other official purposes.

May contain public sector information licensed under the Open Government Licence v3.0.



Project
H2 TEESSIDE

Drawing Title
STAGE 2 CONSULTATION
LAND INTEREST PLAN
NETWORK RAIL INFRASTRUCTURE LIMITED
SHEET 8 OF 9

Status	FINAL	Revision	000
Date	07/12/2023		
Scale	1:1,000 @ A3	Spatial Reference System	British National Grid
Drawn By	J.NEYE-SWIFT	Checked By	N/A
Approved By			J.WITHINGTON
Drawing reference	073_ARDG_H2Teesside_LIC		

This document is not to be used in whole or in part other than for the intended purpose and project for which it was prepared and provided.

Plot Date: 07 December 2023 15:08
File Name: C:\Users\Jaken\Arden\Management\1\td\Projects - Aecom - H2 Teesside\IP16 - GIS & CAD Files\073_ARDG_Teeside\ArcPro - Projects\Re-Consultation Plans\073_ARDG_H2Teesside_LIC_Batch_3_LOP.aprx

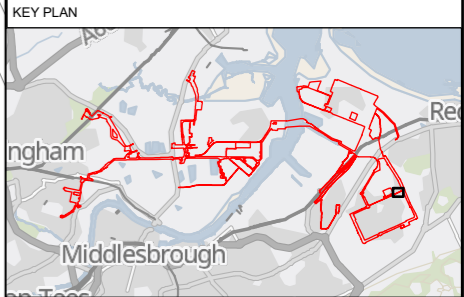
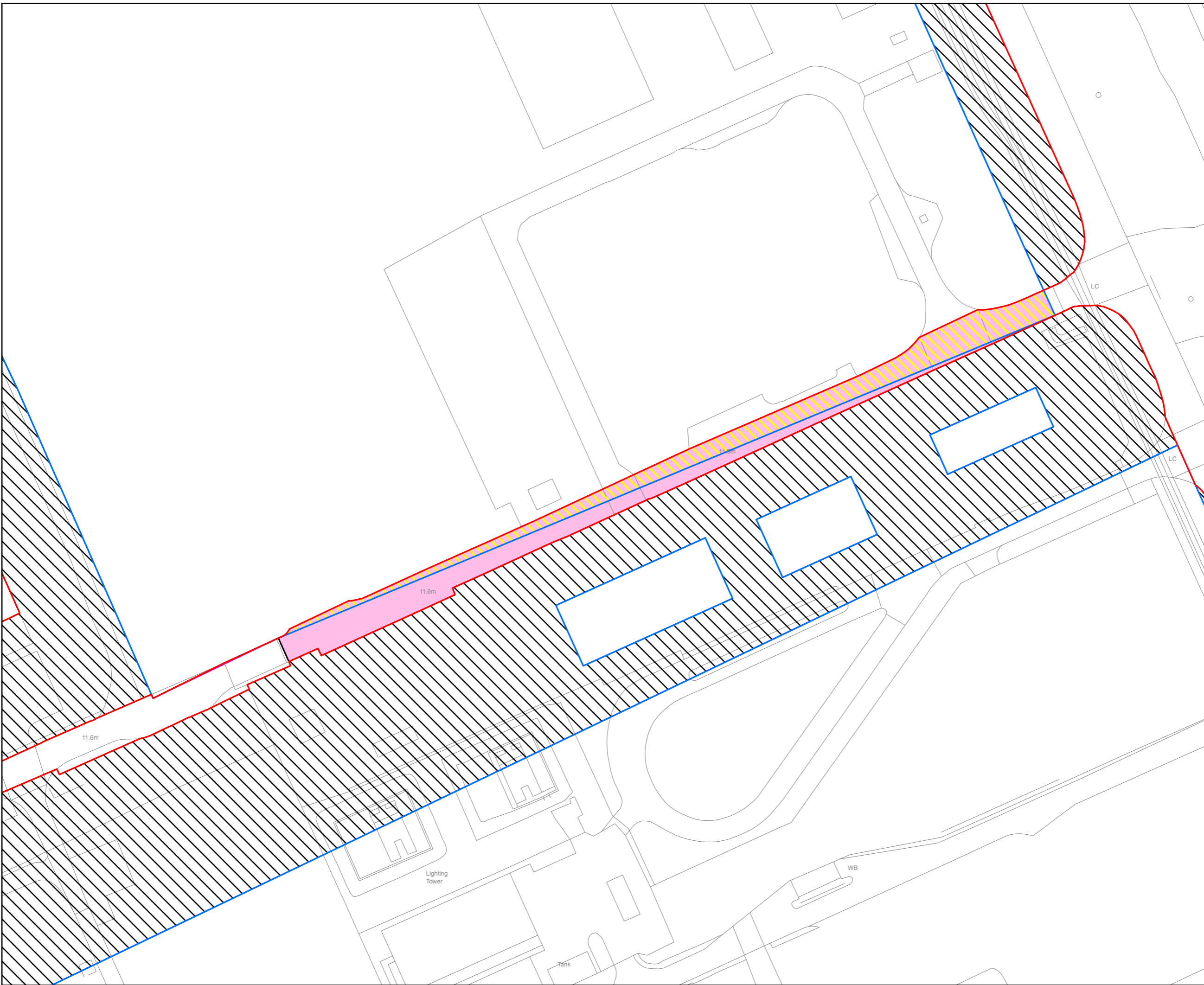

- Key
- Revised Draft Order Limits
 - Order Limits shown at Previous Statutory Consultation
 - Land Interest Boundary
 - Additional Land Area Required
 - Land Area Reduced

© Crown copyright and database rights 2023 Ordnance Survey 0100031673. You are permitted to use this data solely to enable you to respond to, or interact with, the organisation that provided you with the data. You are not permitted to copy, sub-licence, distribute or sell any of this data to third parties in any form.

© Crown copyright material is reproduced with the permission of Land Registry under delegated authority from the Controller of HMSO.

This material was last updated in September 2023 and may not be copied distributed, sold or published without the formal permission of Land Registry. Only an official copy of a title plan or register obtained from the Land Registry may be used for legal or other official purposes.

May contain public sector information licensed under the Open Government Licence v3.0.



Project
H2 TEESSIDE

Drawing Title
STAGE 2 CONSULTATION
LAND INTEREST PLAN
NETWORK RAIL INFRASTRUCTURE LIMITED
SHEET 9 OF 9

Status	FINAL	Revision	000
Date	07/12/2023		

Scale: 1:1,000 @ A3 Spatial Reference System: British National Grid

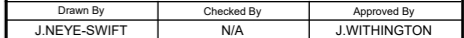

Drawn By	Checked By	Approved By
J.NEYE-SWIFT	N/A	J.WITHINGTON

Drawing reference: 073_ARDG_H2Teesside_LIC

This document is not to be used in whole or in part other than for the intended purpose and project for which it was prepared and provided.