

# Fire Safety Regulations - News

## Licensing Act 2003

Cleveland Fire Brigade, in conjunction with the Licensing Authorities are making preparations for the introduction of the new Licensing Act 2003. This new Act sets four licensing objectives which have to be met, one being public safety which includes fire safety.

The role of Cleveland Fire Brigade will be to notify the Licensing Authorities on whether the standards of fire safety you are proposing, together with the way in which those standards will be managed, are considered to be satisfactory with respect to any of the following:-

New Premises Licence.

New Club Premises Certificate.

Major variation of a Premises Licence or Club Premises Certificate.

Provisional Statement in the case of new premises.

You will be expected to provide Cleveland Fire Brigade with copies of the **application**, the **operating schedule**, a **plan** of the premises and how **fire safety matters** will be addressed.

The **operating schedule** will be an important document which should be carefully compiled by a person who is sufficiently competent. It should include information which is necessary to enable assessments to be made on whether the steps to be taken to promote the licensing objectives are satisfactory. To enable Cleveland Fire Brigade to advise the Licensing Authorities on the suitability of fire safety within your premises, it is important that your **operating schedule** is in the prescribed form. The inclusion of a **Fire risk assessment** covering the points listed below would assist Cleveland Fire Brigade to process applications more efficiently and enable a full and thorough assessment of the fire precautions proposed for the premises to be made.

- Means of escape.
- Normal and emergency lighting.
- Fire warning arrangements.
- Fire-fighting equipment.
- Safe occupancy levels together with arrangements to ensure they are not exceeded.
- Standards of fire performance for surface linings, curtains, drapes and furnishings.
- Arrangements for summoning the Fire and Rescue Service.
- Access for emergency vehicles.
- Staff training.
- Maintenance of safety equipment and systems.
- Testing of electrical wiring and systems.
- Recording of maintenance, tests and training.
- Adequate numbers of attendants.
- Arrangements for the safe use and storage of equipment used for special effects.

Your **plan** of the premises should be drawn to the scale of 1:100, preferably with a legend. For fire safety purposes, it should include the following:-

- The boundary of the building including any external and internal walls along with their associated dimensions and, where necessary, the perimeter of the premises.
- The locations of points of access and egress from the premises including any escape routes.
- In cases where the premises are to be used for more than one licensable activity, those areas used for each activity.
- Fixed or temporarily fixed structures including furniture, which may affect the use of escape routes.

- The location and height of any stage or raised area.
- The location of any steps, stairs, elevators or lifts.
- The location and type of any fire safety equipment including, portable fire extinguishers, fixed fire-fighting equipment, fire resisting doors, fire detection and alarm systems, emergency lighting systems including signs and, where appropriate, any marine evacuation equipment.

Providing Cleveland Fire Brigade with all necessary information will enable us to respond promptly to the Licensing Authorities and assist them in avoiding any delays in processing your application.

### **Floor Plan**

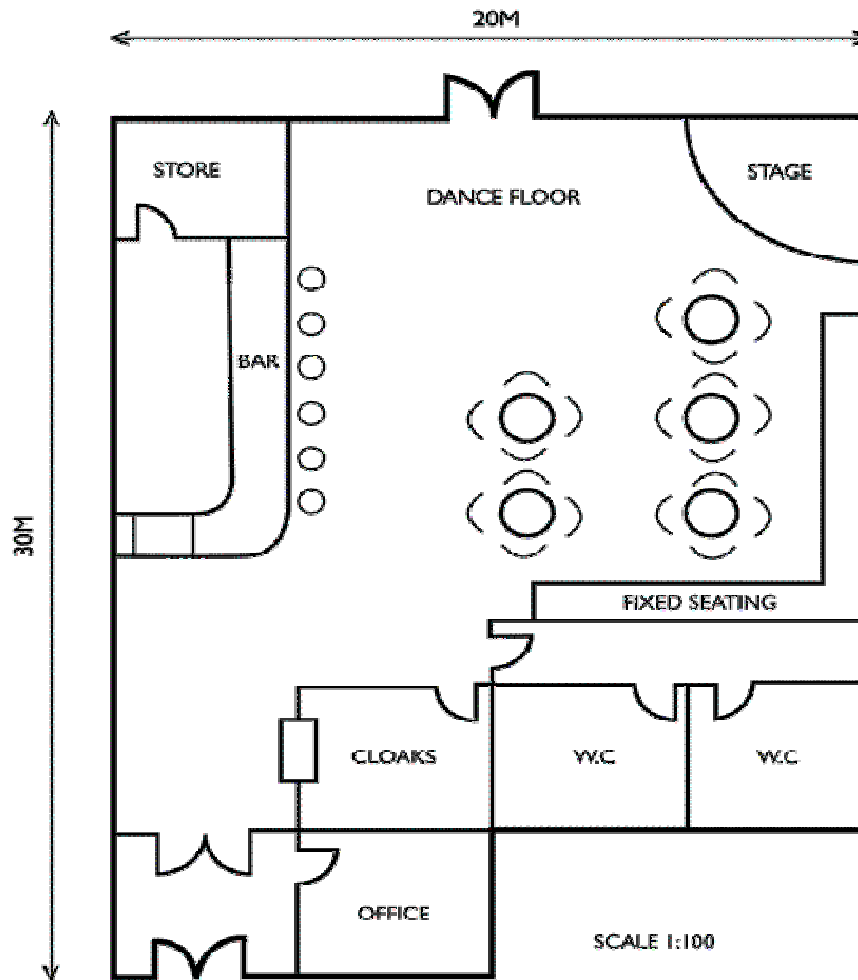

Insert details of fire-fighting equipment, fire detection and alarm systems, emergency lighting and signs along with an appropriate legend.

**For further information please contact the Fire Engineering Department.**

### **Middlesbrough/Redcar & Cleveland District:**

Cleveland Fire Brigade  
 Fire Engineering Division  
 Middlesbrough Fire Station  
 115 Park Road South  
 Middlesbrough  
 TS5 6LG  
 Tel: 01642 851185

Fax: 01642 823552