

Plot Date: 07 December 2023 15:14
 File Name: C:\Users\Jaken\Ardent Management\LT\Projects - Aecom - H2 Teesside\IP16 - GIS & CAD Files\073_ARDG - Teesside\ArcPro Projects\Re-Consultation Plans\073_ARDG_H2Teesside_LIC_Batch_3_LOP.aprx

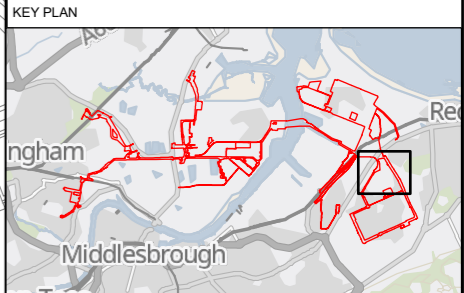
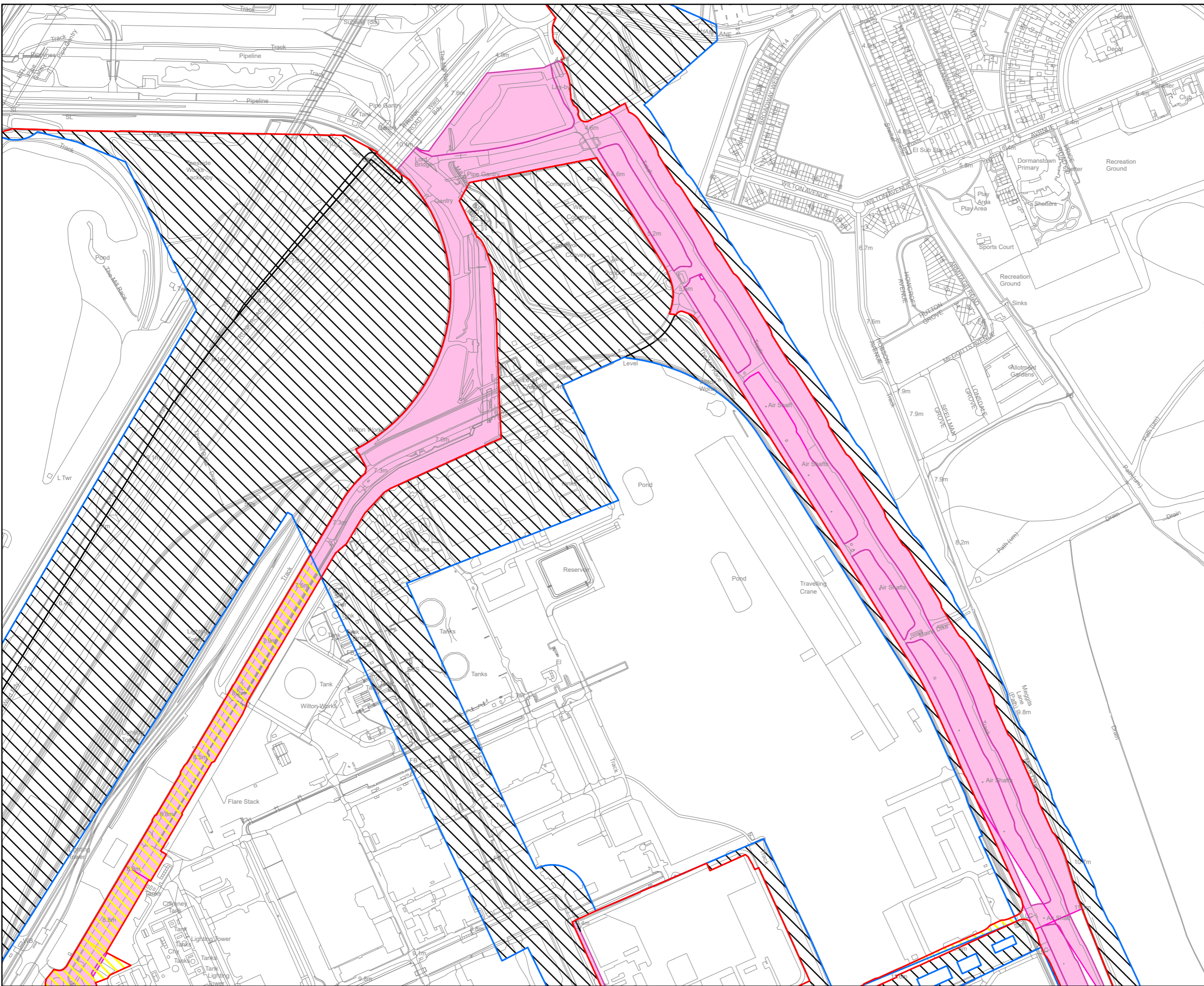

- Key**
- Revised Draft Order Limits
 - Order Limits shown at Previous Statutory Consultation
 - Land Interest Boundary
 - Additional Land Area Required
 - Land Area Reduced

© Crown copyright and database rights 2023 Ordnance Survey 0100031673. You are permitted to use this data solely to enable you to respond to, or interact with, the organisation that provided you with the data. You are not permitted to copy, sub-licence, distribute or sell any of this data to third parties in any form.

© Crown copyright material is reproduced with the permission of Land Registry under delegated authority from the Controller of HMSO.

This material was last updated in September 2023 and may not be copied distributed, sold or published without the formal permission of Land Registry. Only an official copy of a title plan or register obtained from the Land Registry may be used for legal or other official purposes.

May contain public sector information licensed under the Open Government Licence v3.0.

Client



Designer



Project **H2 TEESIDE**

Drawing Title
**STAGE 2 CONSULTATION
 LAND INTEREST PLAN
 SABIC TEES HOLDINGS LIMITED
 SHEET 1 OF 2**

Status	FINAL	Revision	000
Date	07/12/2023		

Scale	1:5,000 @ A3	Spatial Reference System	British National Grid
-------	--------------	--------------------------	-----------------------

Drawn By	J.NEYE-SWIFT	Checked By	N/A	Approved By	J.WITHINGTON
----------	--------------	------------	-----	-------------	--------------

Drawing reference **073_ARDG_H2Teesside_LIC**

This document is not to be used in whole or in part other than for the intended purpose and project for which it was prepared and provided.

Plot Date: 07 December 2023 15:14
 File Name: C:\Users\jake\Arden\Management\IT\Projects - H2 Teesside\PI16 - GIS & CAD Files\073_ARDG_Teeside\Arden\Projects\Re-Consultation Plans\073_ARDG_H2Teesside_LIC_Batch_3_LOP.aprx

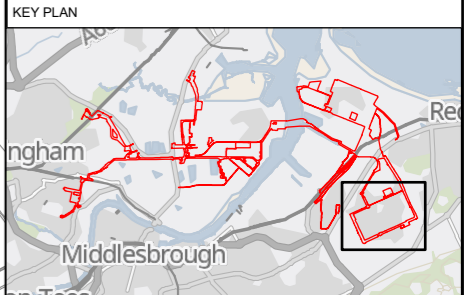
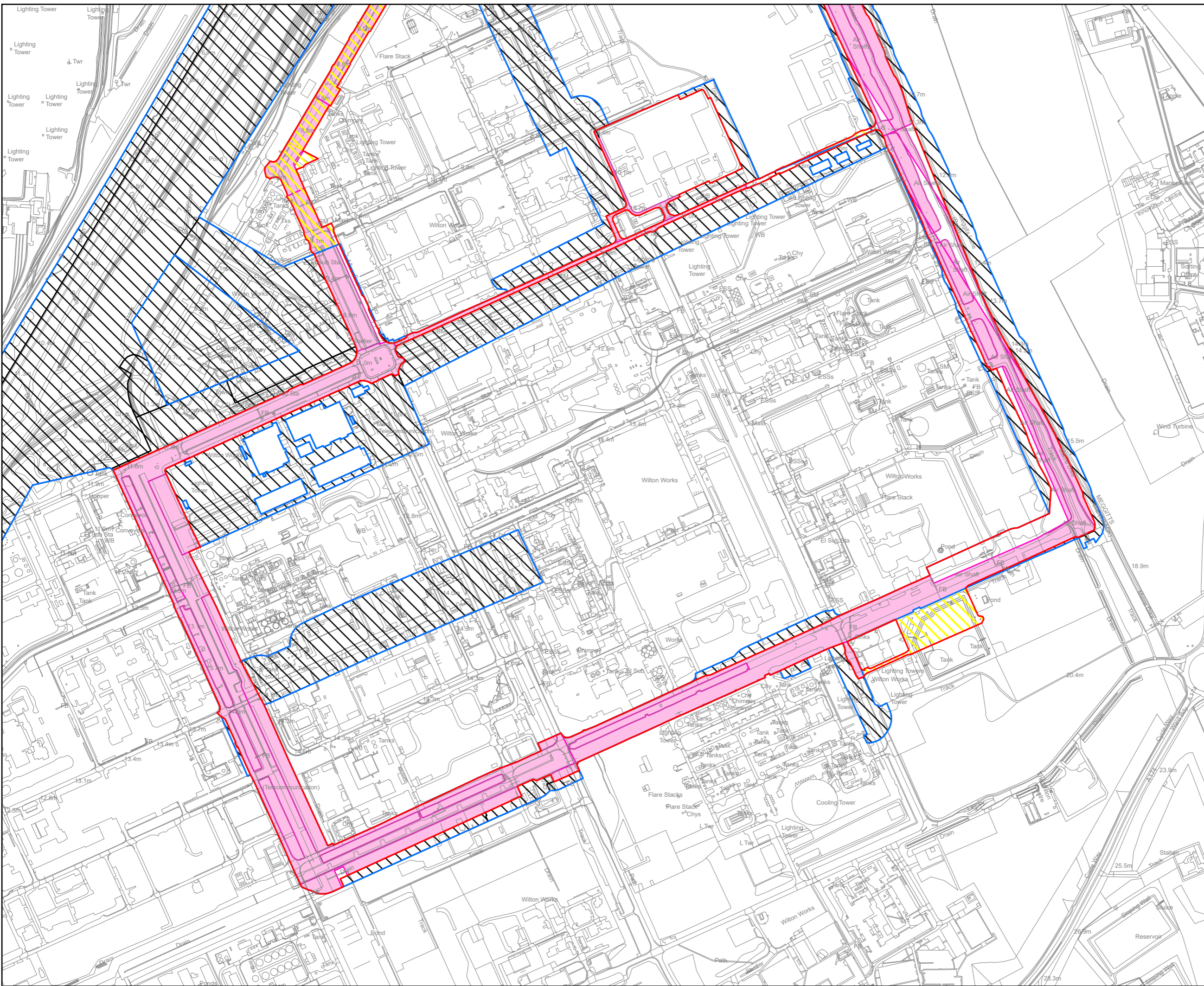

- Key**
- Revised Draft Order Limits
 - Order Limits shown at Previous Statutory Consultation
 - Land Interest Boundary
 - Additional Land Area Required
 - Land Area Reduced

© Crown copyright and database rights 2023 Ordnance Survey 0100031673. You are permitted to use this data solely to enable you to respond to, or interact with, the organisation that provided you with the data. You are not permitted to copy, sub-licence, distribute or sell any of this data to third parties in any form.

© Crown copyright material is reproduced with the permission of Land Registry under delegated authority from the Controller of HMSO.

This material was last updated in September 2023 and may not be copied distributed, sold or published without the formal permission of Land Registry. Only an official copy of a title plan or register obtained from the Land Registry may be used for legal or other official purposes.

May contain public sector information licensed under the Open Government Licence v3.0.



Project **H2 TEESIDE**

Drawing Title
**STAGE 2 CONSULTATION
 LAND INTEREST PLAN
 SABIC TEES HOLDINGS LIMITED
 SHEET 2 OF 2**

Status	FINAL	Revision	000
Date	07/12/2023	Date	07/12/2023
Scale	1:8,000 @ A3	Spatial Reference System	British National Grid
Drawn By	J.NEYE-SWIFT	Checked By	N/A
Approved By	J.WITHINGTON	Approved By	J.WITHINGTON
Drawing reference	073_ARDG_H2Teesside_LIC		

This document is not to be used in whole or in part other than for the intended purpose and project for which it was prepared and provided.