

- Key**
- Revised Draft Order Limits
 - Order Limits shown at Previous Statutory Consultation
 - Land Interest Boundary
 - Additional Land Area Required
 - Land Area Reduced

© Crown copyright and database rights 2023 Ordnance Survey 0100031673. You are permitted to use this data solely to enable you to respond to, or interact with, the organisation that provided you with the data. You are not permitted to copy, sub-licence, distribute or sell any of this data to third parties in any form.

© Crown copyright material is reproduced with the permission of Land Registry under delegated authority from the Controller of HMSO.

This material was last updated in September 2023 and may not be copied, distributed, sold or published without the formal permission of Land Registry. Only an official copy of a title plan or register obtained from the Land Registry may be used for legal or other official purposes.

May contain public sector information licensed under the Open Government Licence v3.0.



Client
Project
H2 TEESSIDE

Drawing Title
**STAGE 2 CONSULTATION
LAND INTEREST PLAN
M & G SOLID FUELS LLP
SHEET 1 OF 3**

Status	FINAL	Revision	000
Scale	1:7,000 @ A3	Date	07/12/2023
Spatial Reference System	British National Grid		

Drawn By	J.NEYE-SWIFT	Checked By	N/A	Approved By	J.WITHINGTON
Drawing reference	073_ARDG_H2Teesside_LIC				

This document is not to be used in whole or in part other than for the intended purpose and project for which it was prepared and provided.

Plot Date: 07 December 2023 12:15
 File Name: C:\Users\Jaken\Arden\Management\1\Projects - Accom - H2 Teesside\IP16 - GIS & CAD Files\073_ARDG_Teeside\ArcPro Projects\Re-Consultation Plans\073_ARDG_H2Teesside_LIC_Batch_2_LOP.aprx

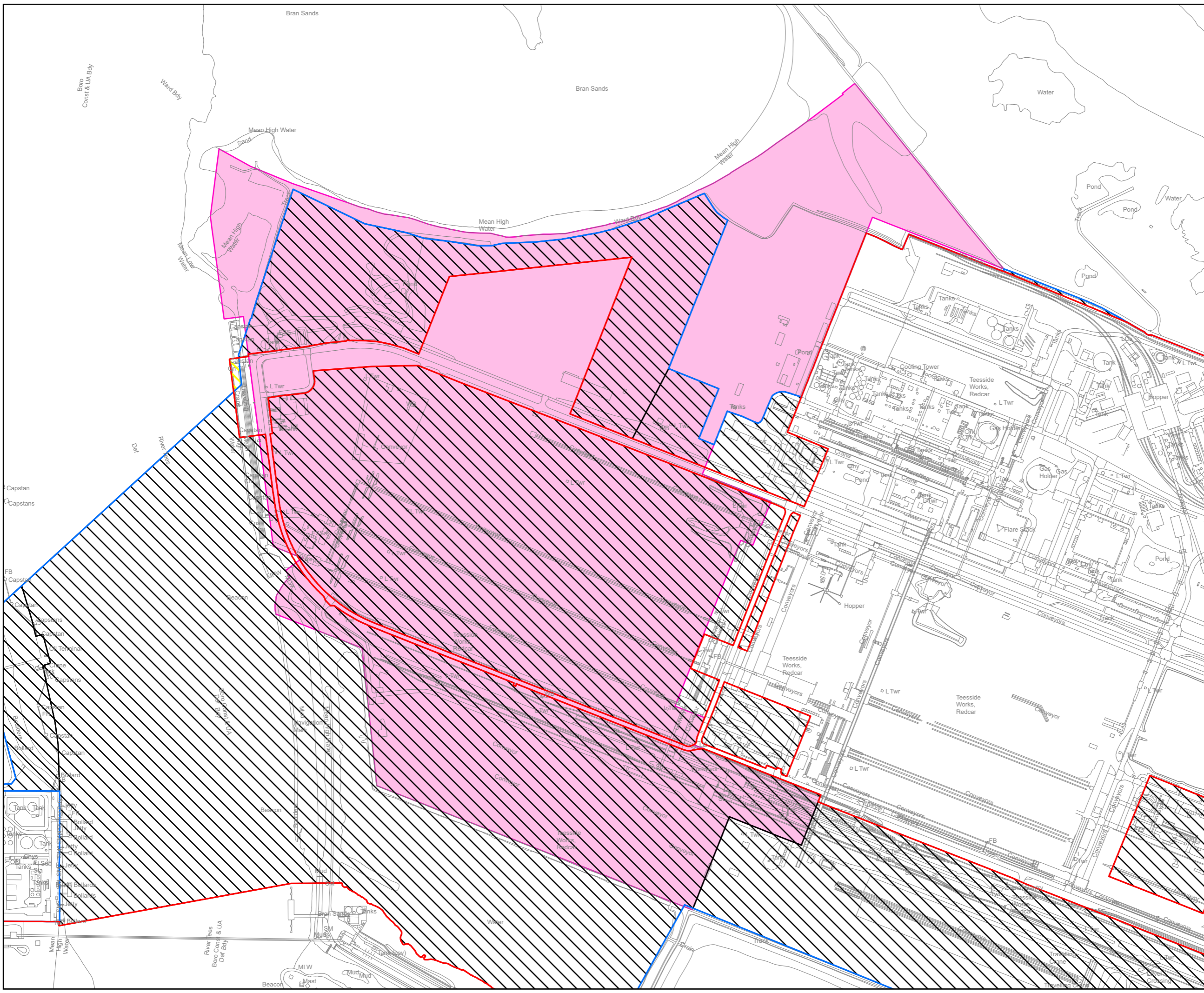

Plot Date: 07 December 2023 12:15
File Name: C:\Users\jake\Arden\Management\1\1\Projects - Accom - H2 Teesside\1\1\Projects - Re-Consultation Plans\073_ARDG_H2Teesside_LIC_Batch_2_LOP.aprx

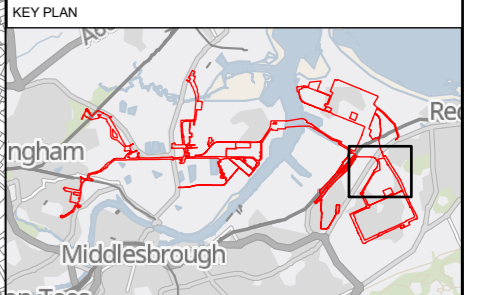
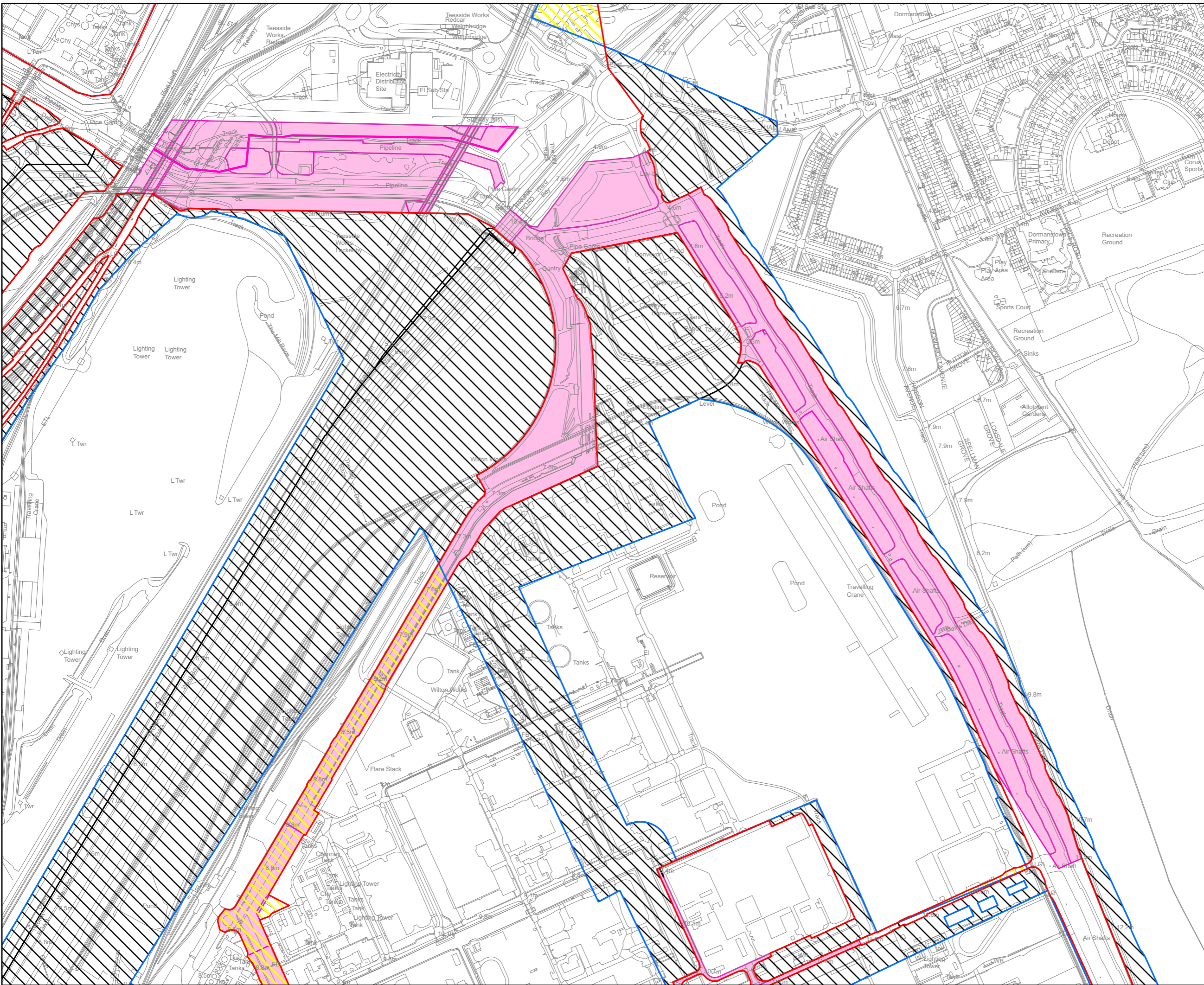

- Key**
- Revised Draft Order Limits
 - Order Limits shown at Previous Statutory Consultation
 - Land Interest Boundary
 - Additional Land Area Required
 - Land Area Reduced

© Crown copyright and database rights 2023 Ordnance Survey 0100031673. You are permitted to use this data solely to enable you to respond to, or interact with, the organisation that provided you with the data. You are not permitted to copy, sub-licence, distribute or sell any of this data to third parties in any form.

© Crown copyright material is reproduced with the permission of Land Registry under delegated authority from the Controller of HMSO.

This material was last updated in September 2023 and may not be copied distributed, sold or published without the formal permission of Land Registry. Only an official copy of a title plan or register obtained from the Land Registry may be used for legal or other official purposes.

May contain public sector information licensed under the Open Government Licence v3.0.



Project: H2 TEESSIDE

Drawing Title: STAGE 2 CONSULTATION LAND INTEREST PLAN M & G SOLID FUELS LLP SHEET 2 OF 3

Status	FINAL	Revision	000
Scale	1:6,000 @ A3	Date	07/12/2023
Spatial Reference System	British National Grid	Drawn By	J.NEYE-SWIFT
		Checked By	N/A
		Approved By	J.WITHINGTON
Drawing reference	073_ARDG_H2Teesside_LIC		

This document is not to be used in whole or in part other than for the intended purpose and project for which it was prepared and provided.

Plot Date: 07 December 2023 12:16
 File Name: C:\Users\JW\OneDrive\Arden Management Ltd\Projects - Accom - H2 Teesside\PI16 - GIS & CAD Files\073_ARDG_H2Teesside\Arden\Projects\Re-consultation Plans\073_ARDG_H2Teesside_LIC_Batch_2_LOP.aprx

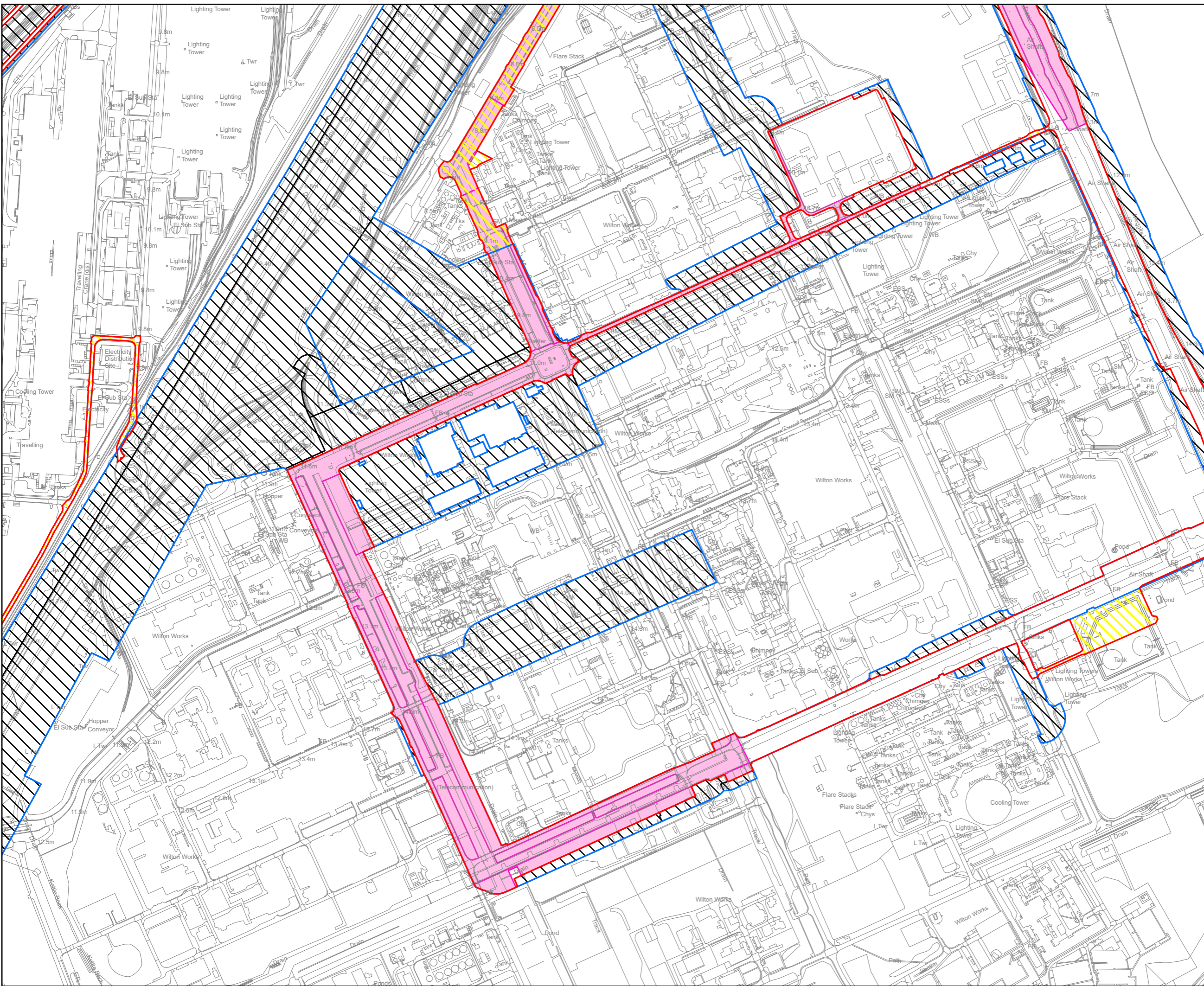

KEY PLAN

Key

- Revised Draft Order Limits
- Order Limits shown at Previous Statutory Consultation
- Land Interest Boundary
- Additional Land Area Required
- Land Area Reduced

© Crown copyright and database rights 2023 Ordnance Survey 0100031673. You are permitted to use this data solely to enable you to respond to, or interact with, the organisation that provided you with the data. You are not permitted to copy, sub-licence, distribute or sell any of this data to third parties in any form.

© Crown copyright material is reproduced with the permission of Land Registry under delegated authority from the Controller of HMSO.

This material was last updated in September 2023 and may not be copied distributed, sold or published without the formal permission of Land Registry. Only an official copy of a title plan or register obtained from the Land Registry may be used for legal or other official purposes.

May contain public sector information licensed under the Open Government Licence v3.0.

Client

Designer

Project

H2 TEESSIDE

Drawing Title

**STAGE 2 CONSULTATION
 LAND INTEREST PLAN
 M & G SOLID FUELS LLP
 SHEET 3 OF 3**

Status	FINAL	Revision	000
Date	07/12/2023		
Scale	1:8,000 @ A3	Spatial Reference System	British National Grid

Drawn By	J.NEYE-SWIFT	Checked By	N/A	Approved By	J.WITHINGTON
----------	--------------	------------	-----	-------------	--------------

Drawing reference: 073_ARDG_H2Teesside_LIC

This document is not to be used in whole or in part other than for the intended purpose and project for which it was prepared and provided.